

Lewmar Service Manual Volume II

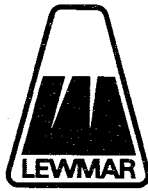

Warranty Details

Lewmar winches have been developed over many years by extensive testing aboard the world's finest ocean racers, long distance cruising yachts and match racing yachts such as 12 metres. They are manufactured to quality standards in excess of those required by Lloyds and only the finest materials are used.

If installed, used and maintained as described in this Manual, they will give outstanding performance.

Lewmar undertake that any winch which proves defective in materials or workmanship within one year of the date of supply will be repaired or replaced **FREE OF CHARGE** provided that the winch is returned by the registered owner to the nearest Lewmar office or distributor for examination. Lewmar reserve all rights on determining the nature of the alleged fault and their decision is final.

Any warranty expressed or implied is ineffective unless the winch has been installed, used and regularly serviced in accordance with our instructions.

Service Notes

For satisfactory long term performance and product life these winches must be given the routine and full maintenance procedure described in the individual maintenance leaflets.

A MONTHLY: All Lewmar winches should be lightly oiled and greased as detailed in the separate free leaflet, "How to service your Lewmar Winch".

B TWO OR THREE TIMES DURING ACTIVE SAILING SEASON: All Lewmar winches should be stripped, cleaned and relubricated.

C AT THE END OF EACH SAILING SEASON OR BEFORE STARTING THE NEW SEASON:

All Lewmar winches should be completely stripped (including removal from mountings where necessary), cleaned, thoroughly checked for damage, lubricated and reassembled as detailed in this Service Manual.

Dismantling

Lewmar winches are simple to dismantle and are designed for easy maintenance. Full details of necessary techniques are

provided in this Service Manual. No other sequence of dismantling should be used.

Assembly

Winches must be assembled in the sequence detailed in this Service Manual.

Mounting

All winches must be mounted using **the correct size and type** of retaining bolts. Having decided on the correct winch position, the drum must be removed as detailed in the maintenance instructions for mounting. The winch must be mounted on a **flat clean** surface.

The hole centres for the winch retaining bolts must be marked off and drilled separately. The winch should be bedded on a **LIGHT** coating of sealing compound to stop leaks - too much compound gets in the gears and pawls.

The winch retaining fastenings must be securely tightened (but not overtightened). The winch is self draining and care must be taken to ensure the drain holes are not blocked.

Handles

All current winches accept any standard International handle (Lewmar red grip handle). For winches manufactured prior to conversion to International size, use a 5/8" square drive handle with a black grip. These handles are still being manufactured.

Recommended Lubricants

Grease
Lewmar Grease (7385)
(Lubriplate Marine Lube 'A' etc.)
Oil
Light Machine oil
(3 in 1 or equivalent)

Service and Spares

Full service facilities for Lewmar winches are provided at our factory and subsidiary companies and by our distributors and service centres worldwide. A full listing is provided for this Manual.

Spares kits for each winch are available and are listed on the individual maintenance leaflets.

Circlip Kits

Contain all necessary retaining circlips (12 off).

Owners are strongly recommended to carry spare circlips for all winches.

Current Winches

Part No. 7060
Winch Nos. 6, 7, 8, 10, 16, 25,
30, 40, 43, 44, 48, 55, 65, 1H
Part No. 7160
Winch No. 2H

Old Style

5/8" handle socket
Part No. 1328
Winch Nos. 8, 16, 1H, 2H

11/16" handle socket

Part No. 7160
Winch Nos. 8, 16, 1H

Tools Required

For routine servicing:
Winch Nos. 6, 7, 8, 10, 16, 25,
30, 40, 43, 44, 48, 55, 65, 1H
Small screwdriver or knife blade
Clean non-fluffy cloth
Cleaning fluid
Lubricants
3/16" AF Allen key for Winch
Nos. 42ST, 44ST, 48ST, 55ST,
65ST, **only.**

Extra for full service:

Winch Nos. 6, 7, 8, 10, 16(new), 30
Nil

Winch Nos. 16(old), 25, 40, 43,
44, 48

Medium screwdriver
Flat nosed drift and hammer

Model 55
Screwdriver
Flat nosed drift and hammer
3/8" AF Allen key

Model 65
Medium screwdriver
Flat nosed drift and hammer
3/8" AF Allen key
7/32" AF Allen key
1/2" BSF spanner

Model 1H
1/8" AF Allen key
3/16" AF Allen key

Model 2, 2x2, 3
1/8" AF Allen key
5/32" AF Allen key

Parts pricing is subject to change. Apply to your nearest Lewmar office or distributor for current price lists.

Contents Volume 1

WINCHES	INTRODUCTION DATE	DISCONTINUED
Single Speed		
6 & 7	LATE 1975	
8 & 10	LATE 1975	
Two Speed		
16	1972	SPRING 1978
25	EARLY 1976	SPRING 1978
40	EARLY 1976	
43	EARLY 1976	
Three Speed		
44	LATE 1974	
48	LATE 1974	
55	LATE 1974	
65 Mark I	LATE 1974	EARLY 1976
65 Mark II	EARLY 1976	
Self-Tailing		
40	AUTUMN 1976	LATE 1976
44	SPRING 1976	SUMMER 1977
48	SPRING 1976	SUMMER 1977
55	SPRING 1976	SUMMER 1977
65	SPRING 1976	SUMMER 1977
Grinders & Linkage		
80	EARLY 1976	
94	1973	LATE 1977
95	1973	LATE 1977
96	1976	
Pedestals		
1379/3840	1973	SPRING 1977

Contents Volume II

WINCHES	INTRODUCTION DATE	DISCONTINUED
Single Speed		
* 6 & 7	LATE 1975	
* 8 & 10	LATE 1975	
Two Speed		
16	SPRING 1978	
30	SPRING 1978	
* 40	EARLY 1976	
* 43	EARLY 1976	
Three Speed		
* 44	LATE 1974	
* 48	LATE 1974	
* 55	LATE 1974	
* 65 Mark II	EARLY 1976	
Self-Tailing		
16	EARLY 1978	
30	EARLY 1978	
34 Mark I	EARLY 1977	SPRING 1978
34 Mark II	SPRING 1978	
42	SUMMER 1978	
* 44	SPRING 1976	
* 48	SPRING 1976	
* 55	SPRING 1976	
* 65	SPRING 1976	
Grinders & Linkage		
* 80	EARLY 1976	
Halliard Reel		
1 Mark I	SUMMER 1975	SPRING 1978
1 Mark II	SPRING 1978	
2	EARLY 1976	
2 x 2	EARLY 1976	
3	EARLY 1976	
Included in Volume I	See overleaf for contents of Volume I	

Fold out

Lewmar

Two speed winches

Model 30

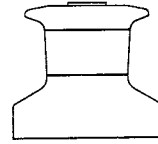

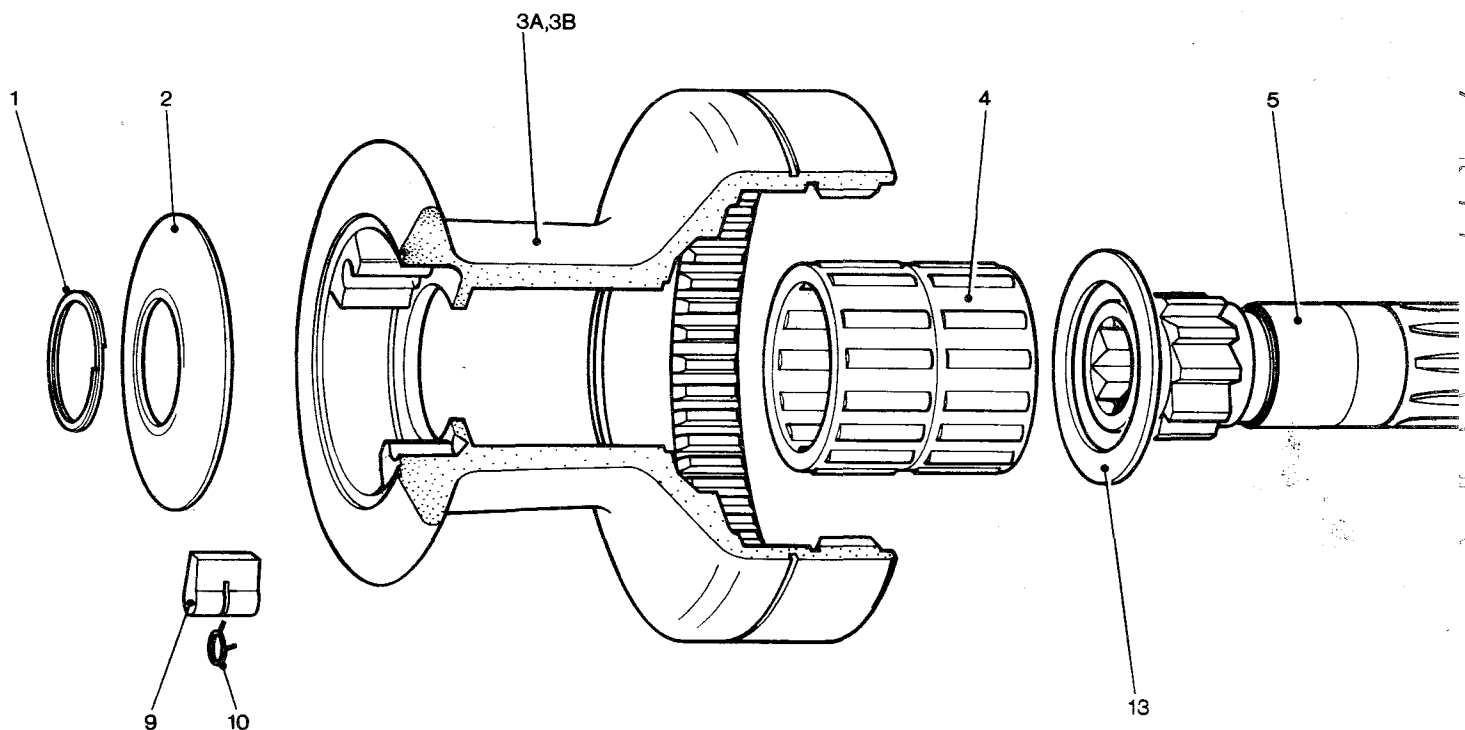
**Maintenance No. 30**

A Using a small screwdriver or knife-blade, remove circlip (1).

B Lift drum (3) from centre stem (12).

C Remove top cap (2) from drum (3).

D Removing bearings (4) and drum washer (13) from centre stem (12).

E Extract key (6) from centre stem (12).

F Remove spindle (5) from centre stem (12).

G Remove ratchet gear assembly (8 & 11) from centre stem (12) by turning and lifting retaining spindle (7). Separate ratchet gear (8) from pawl gear (11).

H Clean thoroughly all parts using kerosene (paraffin) or white spirit. Dry with a non-fluffy cloth.

I Check that pawls and springs (9 & 10) in pawl gear (11) are free and oil lightly.

J Replace ratchet gear (8) on pawl gear (11) ensuring that recess on ratchet gear (8) fits over shoulder on pawl gear (11).

K Replace ratchet gear assembly (8 & 11) and retaining spindle (7). Turn and lock retaining spindle

(7) in centre stem (12). Lightly grease ratchet gear assembly.

L Lightly grease spindle (5) and replace in centre stem (12).

M Insert key (6) into centre stem (12) ensuring that key is located in groove of spindle (5).

N Replace drum washer (13) and bearings (4) over centre stem (12) and lightly grease.

O Check that pawls and springs (9 & 10) in drum (3) are free and oil lightly.

P Lightly grease drum gear teeth and refit drum (3) over centre stem (12).

Q Replace top cap (2) and fit circlip (1) ensuring it is correctly located in groove of spindle (5).

No 30

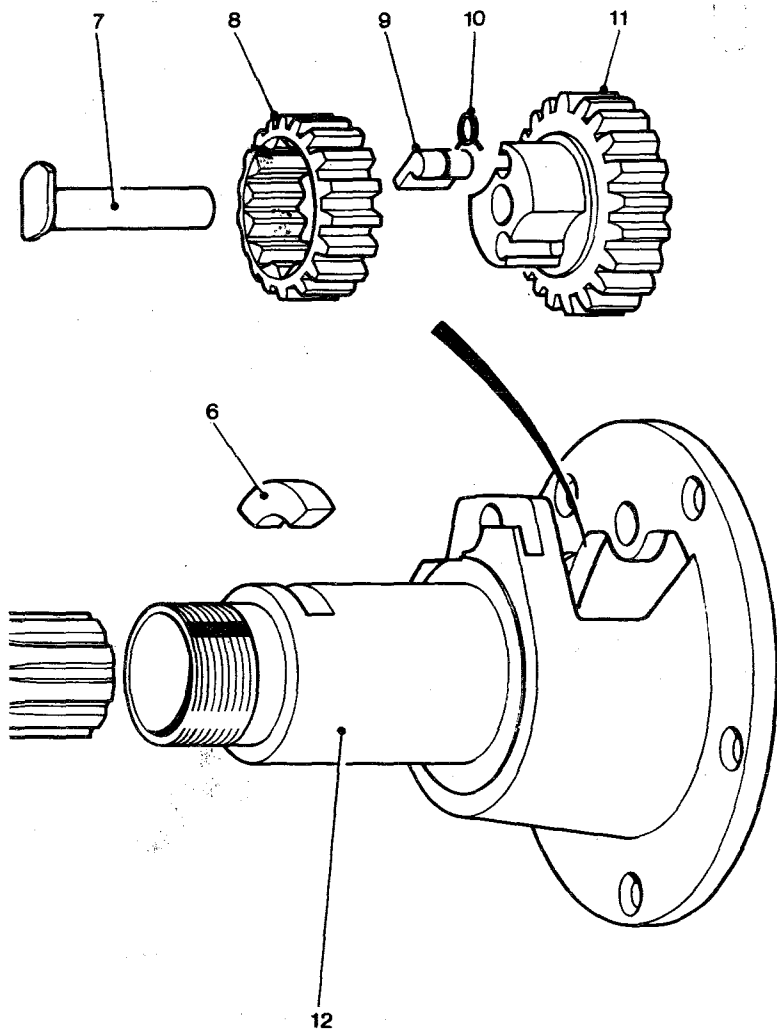

Parts list

Item Number	Part Number	Description	No. Off
1	B2075	Spirolox Circlip	1
2	15010006	Top Cap	1
3A	15030102	Drum (Bronze)	1
3B	15030202	Drum (Aluminium)	1
4	15008007	Cage Assembly Bearing	2
5	18030003	Spindle Assembly	1
6	15008005	Key	1
7	15030004	Idler Spindle	1
8	15030005	Ratchet Gear	1
9	1260/8	Pawl	4
10	1260/7	Pawl Spring	4
11	15030006	Pawl Gear	1
12	15030001	Centre Stem	1
13	15030007	Washer	1

Spare Parts Kit
 Model No 30
 Part No 19730100
 Contents
 1 x Key Pt No 15008005
 4 x Spring Pt No 1260/7
 4 x Pawl Pt No 1260/8
 1 x Circlip Pt No B2075
 1 x Washer Pt No 15030007

Fold out

Lewmar
Two speed winches

Model 40

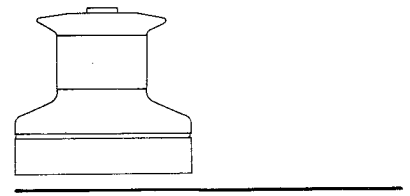

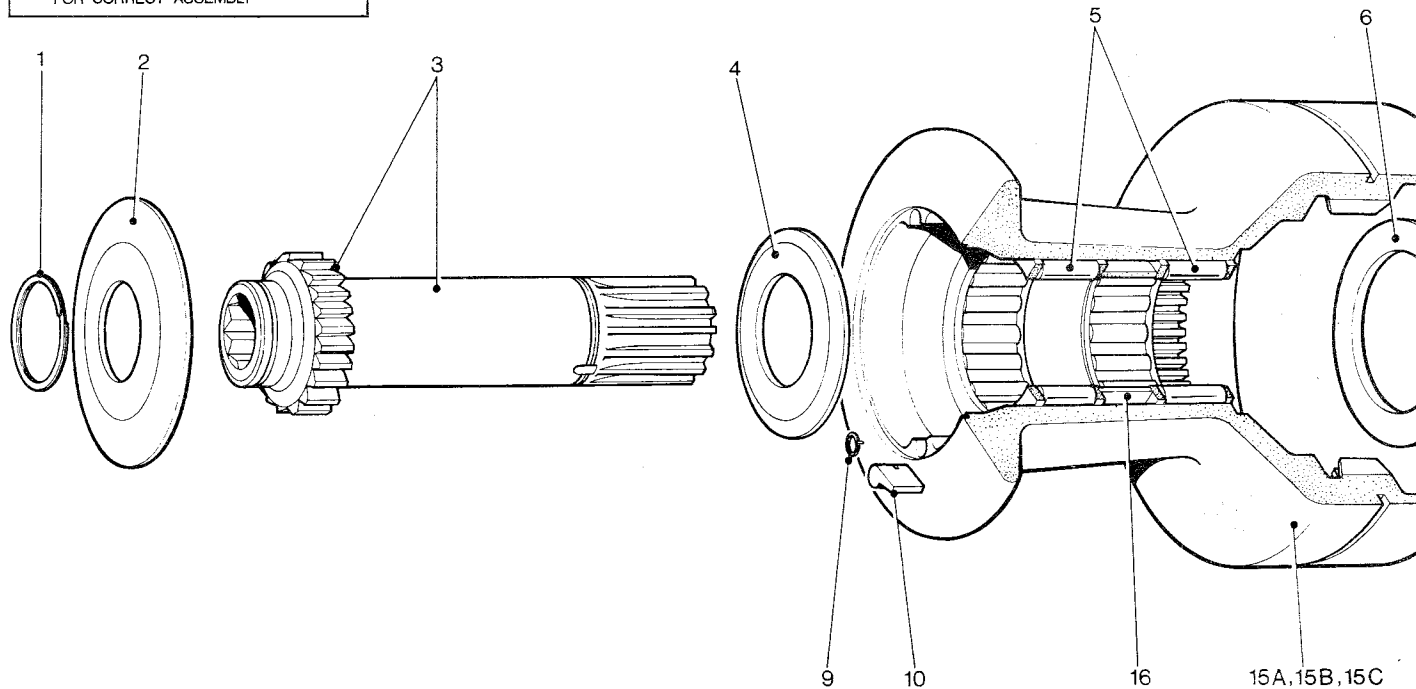
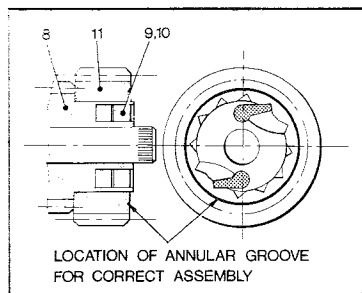

Maintenance No. 40

A Remove circlip (1) using a small screwdriver or knife blade.
B Lift drum (15) and cover plate (2) from centre stem (14).
C Remove cover plate (2) from drum (15).

The winch is now ready for routine monthly maintenance.

D Clean off excess grease and salt deposits from bearing surface of drum (15) centre stem (14) and roller bearings (5).

E Check free operation of pawls (10) in upper part of drum.

F Check free operation of ratchet gear assembly (parts 7-12) by rotating large gear.

G Check free rotation of spindle (3) in centre stem (14).

H If satisfactory proceed with routine maintenance. If not continue to **Full Annual Service**.

I Lightly grease the bore of the drum (15) and roller bearings (5).

J Lightly oil ratchet gear assembly (parts 7-12) and centre spindle (3).

K Apply grease sparingly to gear teeth of ratchet assembly (7-12).

L Lightly oil pawls (10).

M Reassemble drum (15) to centre stem (14) by introducing drum over centre stem and

holding top pawls in the open position to facilitate engagement with the spindle ratchet track.
N Rotate drum to check freedom of pawl movement and correct engagement.

O Replace top cap.

P Replace circlip (1) by entering one end into groove and winding circlip into place.

Q Using handle check free operation of winch and correct engagement of pawls.

Full Annual Service.

R To completely dismantle the winch the mounting bolts must be removed and the winch lifted from the deck.

S Dismantle as steps A - C.

T Remove two pawls (10) and two pawl springs (9) from drum.

U Support the centre stem assembly (14) on its base on a firm structure (work bench etc.). Ensure the lower exit of bearing spindle (7) is not covered.

V Using a flat ended drift tap out the bearing spindle **DOWNWARDS**.

W Remove the ratchet gear assembly (8-12).

X Separate the upper and lower gears (8) and (11) and cover plate (12).

Y Remove two pawls (10) and two springs (9) from ratchet

gear (8).

Z Remove lower circlip (1) and tab washer (13) with a small screwdriver or knife blade.

A1 Withdraw spindle (3) from centre stem (14).

B1 Withdraw washer (6) roller bearings (5) spacer (16) and drum washer (4) from centre stem (14).

C1 Carefully wash drum, centre stem, spindle, roller bearings, gears, washers, pawls and pawl springs.

D1 Lightly grease drum bore, roller bearings, centre stem bearing area and spindle.

E1 Slide drum washer (6) roller bearings (5) spacer (16) and washer (4) onto centre stem (14). Ensure that roller bearings (5) are separated by spacer (16).

F1 Insert spindle (3) and replace tab washer (3) and lower circlip (1), making sure that Tab engages in slot in bottom of spindle.

G1 Replace two pawls (10) and springs (9) in ratchet gear (8) lightly oil.

H1 Reassemble the upper and lower ratchet gears (8-11) noting the location of the annular groove for correct assembly (see sketch). Put the washer (12) in place.

I1 Support the centre stem on the gear aperture shoulder and

No. 40

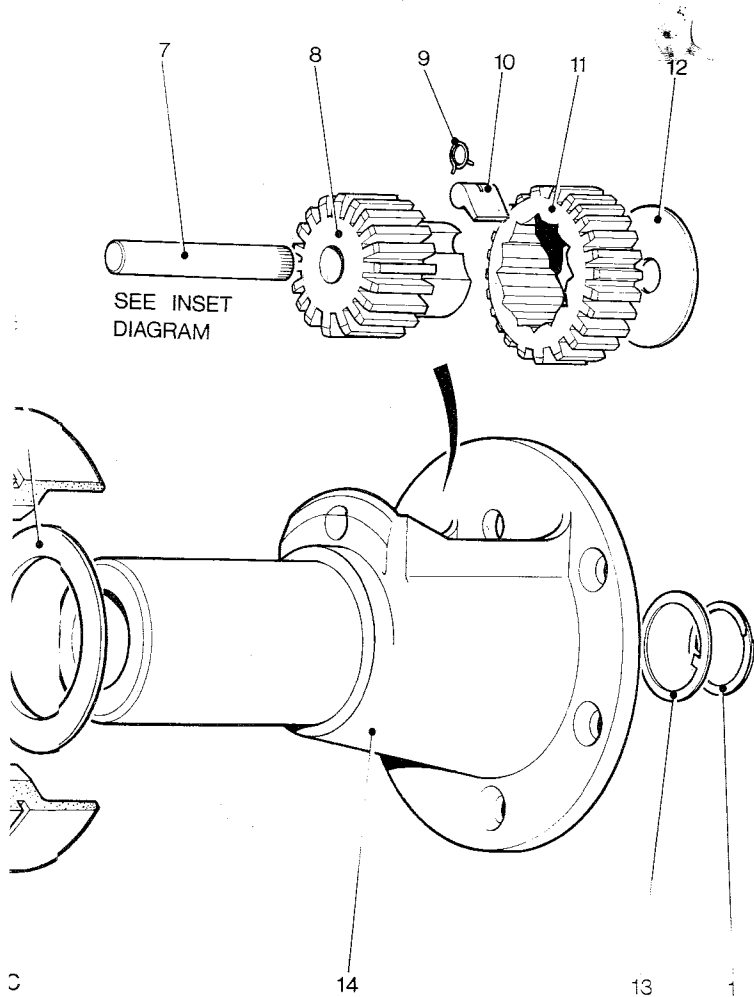

Parts list

Item Number	Part Number	Description	No. Off
1	B2075	Circlip, Spirolox	2
2	15010006	Cap	1
3	1260/SA1	Spindle Assembly	1
4	1300/19	Washer	1
5	1260/SA2	Cage Assembly	2
6	1260/10	Drum Washer	1
7	1260/6	Gear Spindle	1
8	1260/4	Pawl Gear	1
9	1260/7	Spring	4
10	1260/8	Pawl	4
11	1260/5	Ratchet Gear	1
12	1260/9	Gear Washer	1
13	1260/19	Tab Washer	1
14	1260/1	Centre Stem	1
15A	1260/2	Drum, Bronze	1
15B	1255/2	Drum, Alloy	1
15C	1360/2	Drum, Stainless Steel	1
16	1260/11	Tube Spacer	1

insert the ratchet assembly (8-12) into engagement with the spindle (3).

J1 Insert the gear spindle (7) into place and engage with the ratchet gear assembly (8-12).

Ensure correct line up.

K1 With drift tap the gear spindle into place.

L1 Reassemble and check winch as per points I - Q.

M1 If winch fails to perform correctly recheck servicing technique or contact your nearest Lewmar Service point.

Spare Parts Kits

Model 40

Part No 19740400

Contents

1 x Circlip B2075

4 x Spring Pt No 1260/7

4 x Pawl Pt No 1260/8

1 x Washer Pt No 1260/9

2 x Pawl Pt No 15001012

1 x Tab washer Pt No 1260/19

Fold out

MAIN OUTHAUL/REEF



Lewmar
Self-tailing winches

Model 16 ST

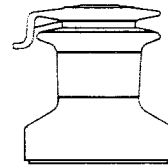

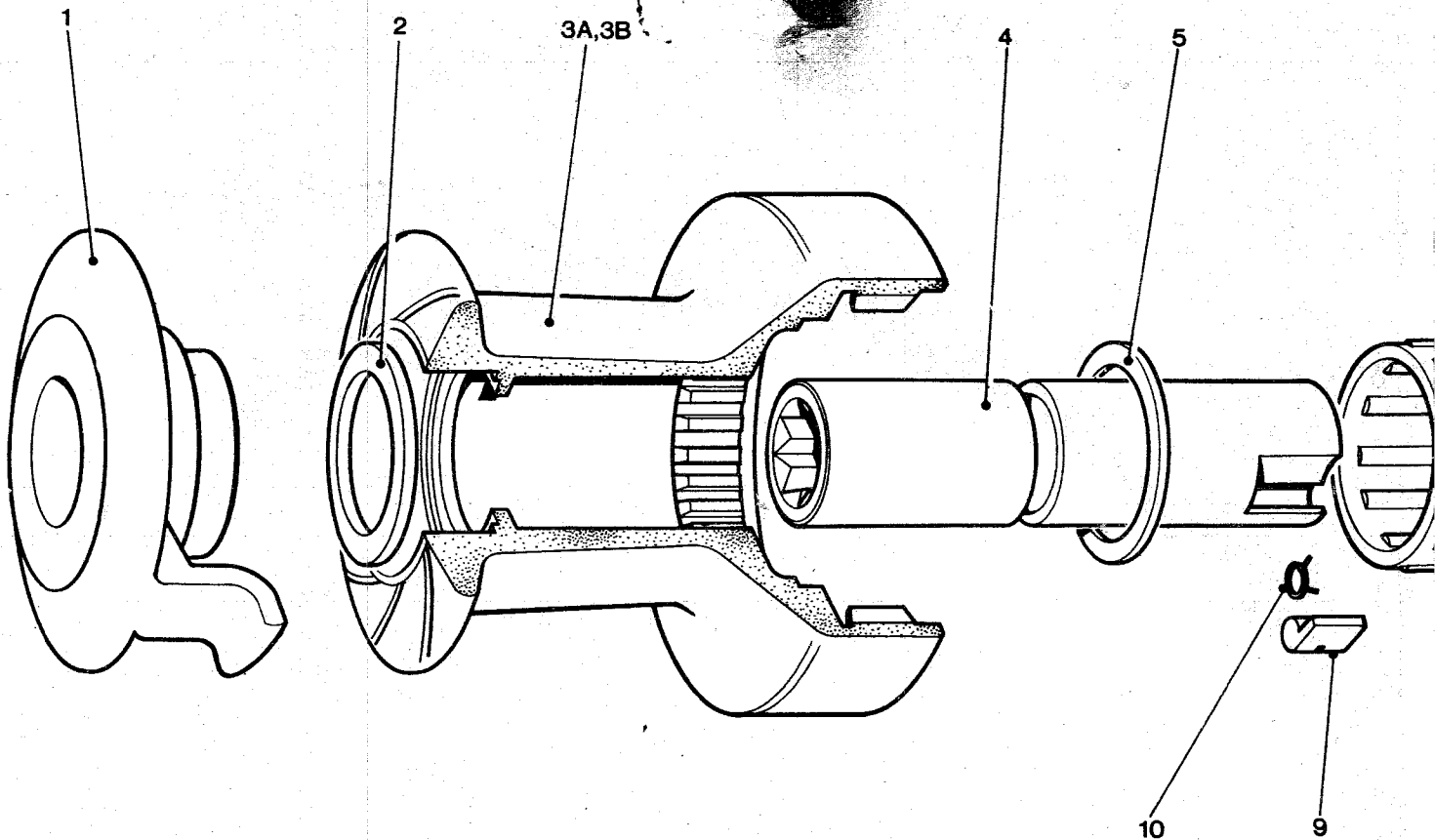
**Maintenance No. 16 ST**

A Using a soft mallet or wooden block and hammer, loosen top cap (1), with a firm tap in an anti-clockwise direction.

B Unscrew and remove top cap (1) from centre stem (7).

C Lift drum (3) from centre stem (7).

D Remove washer (2) from drum (3) and washer (5) from centre stem (7).

E Remove bearings (6) from centre stem (7).

F Extract key (8) from centre stem (7).

G Remove spindle (4) from centre stem (7) by turning in a clockwise direction and lifting.

H Remove idler gear (14) from centre stem (7) by turning and lifting retaining spindle (15).

I Clean thoroughly all parts using kerosene (paraffin) or white spirit. Dry with a non-fluffy cloth.

J Lightly grease ratchet gear (13) on centre stem (7).

K Check that pawls and springs (9 & 10) in centre stem (7) are free and oil lightly.

L Replace idler gear (14) and retaining spindle (15). Lightly grease idler gear (14).

M Check that pawls and springs (9 & 10) in spindle (4) are free and oil lightly.

N Lightly grease spindle (4) and replace in centre stem (7) by turning in a clockwise direction.

O Insert key (8) into centre stem (7) ensuring that key is located in groove of spindle (4).

P Replace bearings (6) over centre stem (7) and lightly grease.

Q Replace washer (5) over centre stem (7).

R Lightly grease drum gear teeth. Refit drum (3) over centre stem (7) and replace washer (2) over centre stem (7).

S Screw top cap (1) to centre stem (7), tighten with a firm tap using a soft mallet or wooden block and hammer.

N.B. When stripping winch, note colour and position of washers (2 & 5) and replace in same order.

If ratchet gear (13) is damaged:
T Remove drum (3) from winch as described above (A) to (C).

U Remove winch from boat and strip as described above (D) to (H).

V Release ratchet gear (13) from winch base by removing circlip (11) and retaining plate (12).

W Replace ratchet gear (13), retaining plate (12) and circlip (11).

X Clean and reassemble as above (I) to (S).

No 16ST

EA. OUT HAUL / REEFING

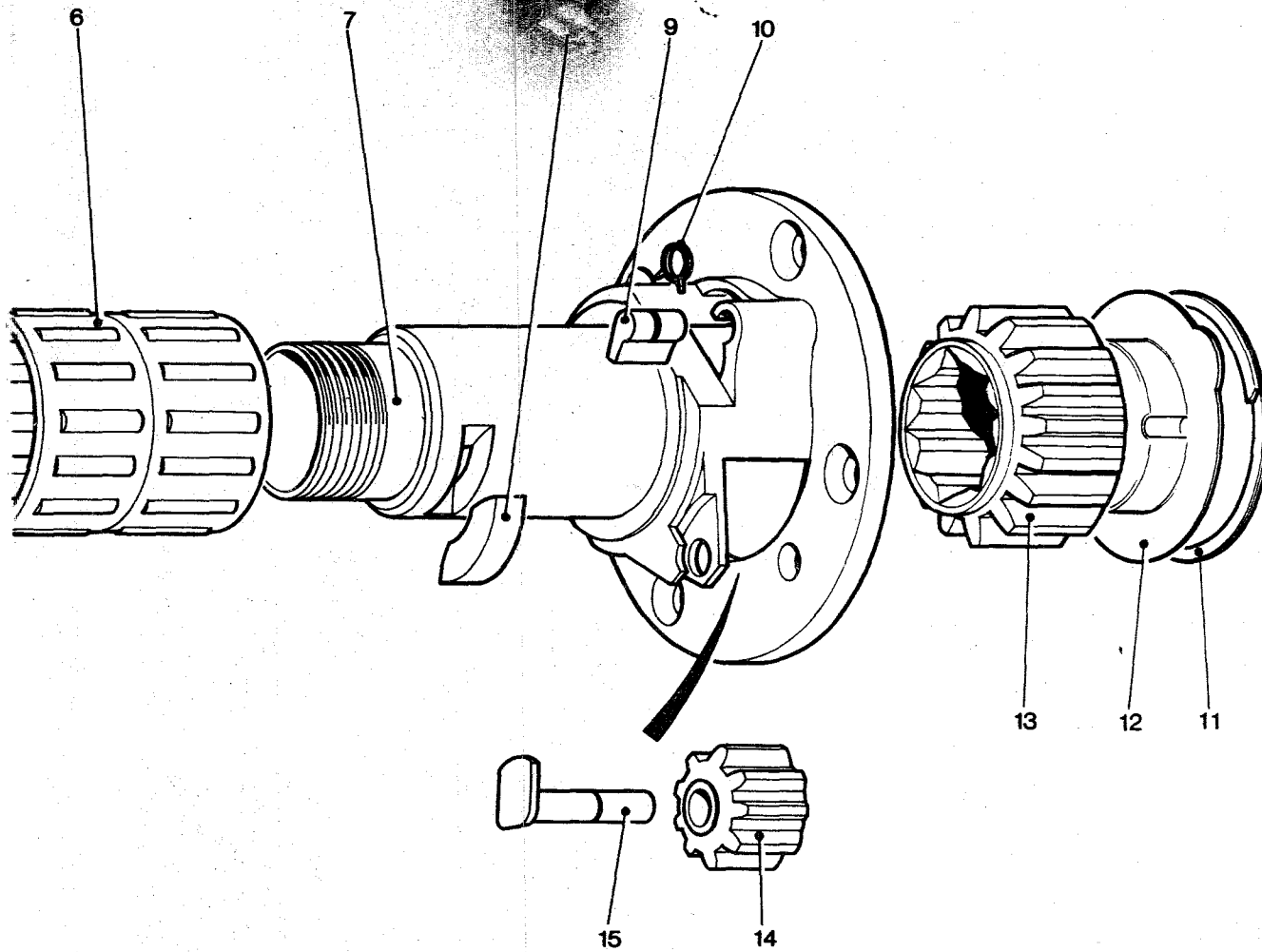

Spare Parts Kit
Model No 16 ST
Part No 19716600

#7167 \$6.50
LIST

Contents

- 1 x Key Pt No 15008005
- 4 x Spring Pt No 1260/7
- 4 x Pawl Pt No 1260/8
- 1 x Washer Pt No 15008004
- 1 x Washer Pt No 15016010

Parts list

Item Number	Part Number	Description	No. Off
1	15016604	Stripper Nut/ Top Cap	1
2	15016010	Washer	1
3A	15016402	Drum (Bronze)	1
3B	15016502	Drum (Alum)	1
4	15016603	Spindle	1
5	15008004	Washer	1
6	15008007	Cage Assembly Bearing	2
7	15016601	Centre Stem	1
8	15008005	Key	1
9	1260/8	Pawl	4
10	1260/7	Pawl Spring	4
11	B2085	Spirolox Circlip	1
12	15016007	Retaining Plate	1
13	15016016	Ratchet Gear	1
14	15016005	Idler Gear	1
15	15016004	Idler Spindle	1

Fold out

STAYSAIL SHEETS (2)

Lewmar
Self-tailing winches

Model 34 ST (Fixed Top)

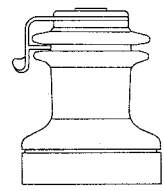

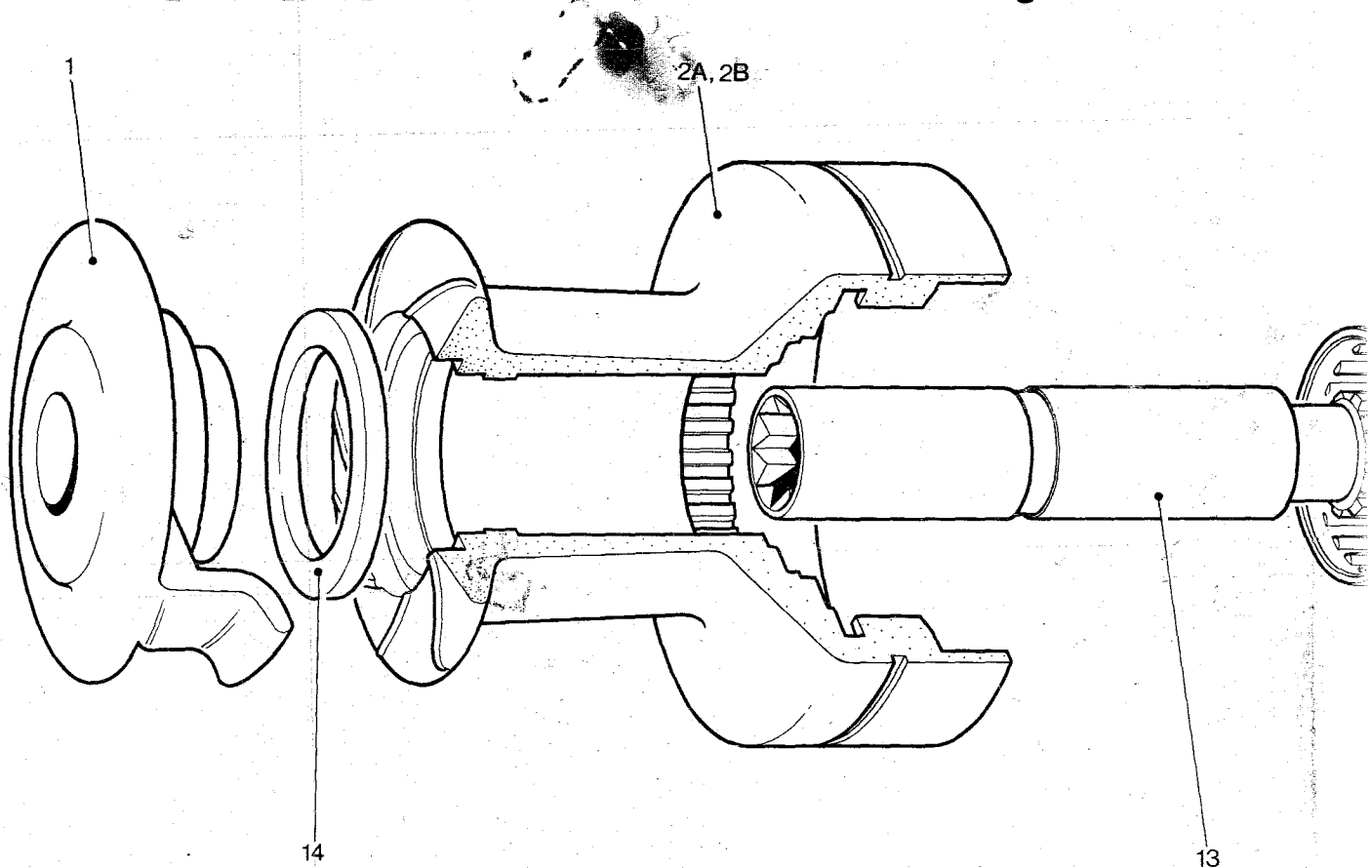
**Maintenance No. 34 ST (Fixed top)**

A Using a soft mallet or wooden block and hammer, loosen top cap (1) with a firm tap in an anti-clockwise direction.

B Unscrew and remove top cap (1) from centre stem (6).

C Lift drum (2) from centre stem (6).

D Remove washer (14) from drum (2).

E Remove bearings (3), spacer (4) and washer (5) from centre stem (6).

F Extract key (9) from centre stem (6).

G Remove spindle (13) from centre stem (6).

H Remove ratchet gear assembly (10 & 11) from centre stem (6) by turning and lifting retaining spindle (12).

I Remove ratchet gear (10) from pawl gear (11).

J Clean thoroughly all parts using kerosene (paraffin) or white spirit. Dry with a non-fluffy cloth.

K Check that pawls and springs (7 & 8) in centre stem (6) are

free and oil lightly.

L Check that pawls and springs (7 & 8) in pawl gear (11) are free and oil lightly.

M Replace ratchet gear (10) on pawl gear (11) ensuring that the recess on ratchet gear (10) fits over shoulder of pawl gear (11).

N Replace ratchet gear assembly (10 & 11) and retaining spindle (12). Turn and lock retaining spindle (12) in centre stem (6).

Lightly grease ratchet gear assembly (10 & 11).

O Lightly grease spindle (13) and replace in centre stem (6).

P Insert key (9) into centre stem (6) ensuring that key is located in groove of spindle (13).

Q Replace washer (5), bearings (3) and spacer (4) over centre stem (6) and lightly grease.

R Lightly grease drum gear teeth. Refit drum (2) over centre stem (6) and replace washer (14) over centre stem (6).

S Screw top cap (1) to centre stem (6). Tighten with a firm tap

using soft mallet or wooden block and hammer.

N.B. When stripping winch, note colour and position of washers (5 & 14) and replace in same order.

No 34ST (Fixed Top)

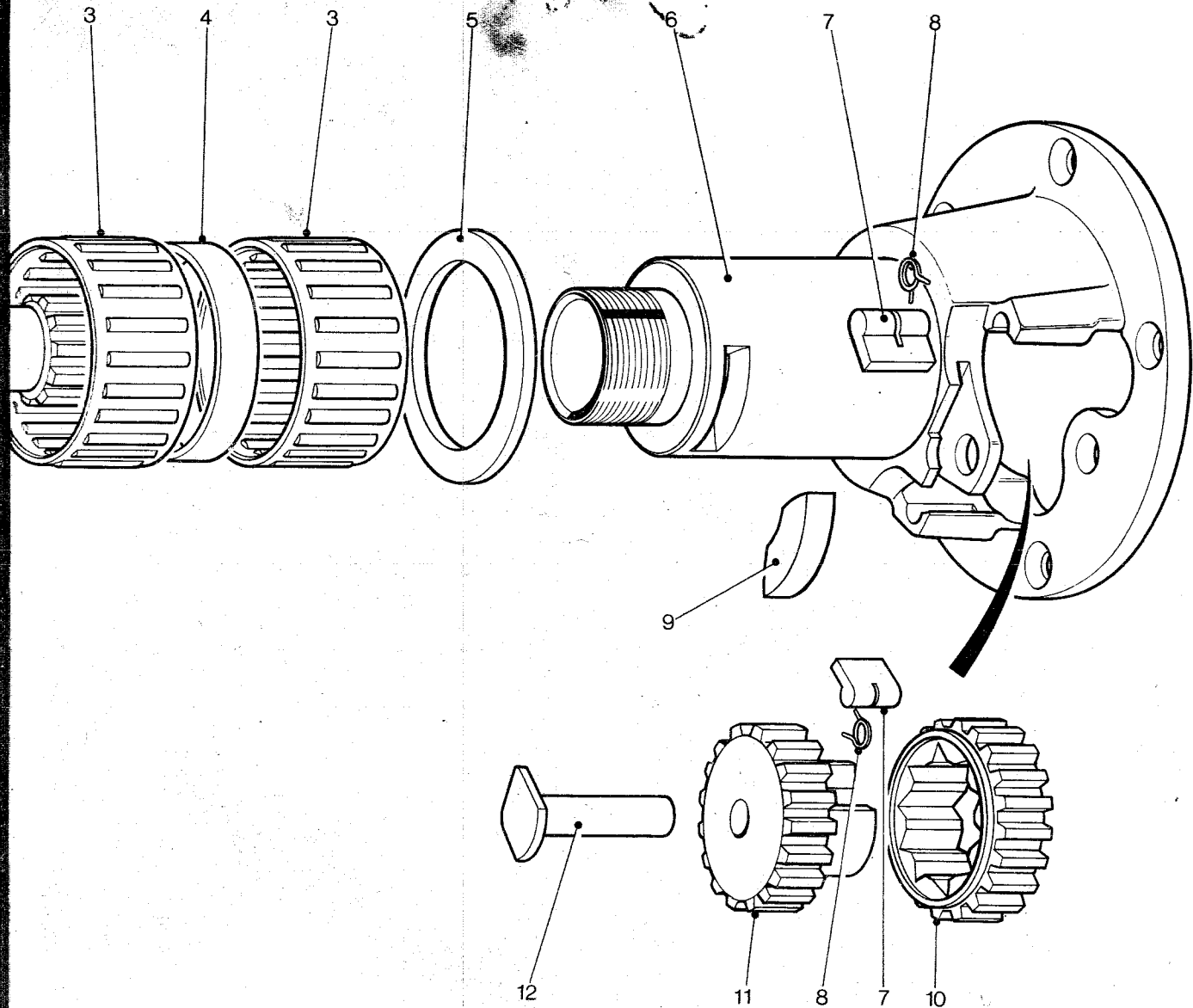

Parts list

Item Number	Part Number	Description	No. Off
1	13034634	Stripper Nut/ Top Cap	* 1
	B2404	Helicoil	
2A	15034432	Drum (Bronze)	1
2B	15034532	Drum (Alum)	1
3	15010007	Cage Assembly Bearing	2
4	15010008	Spacer	1
5	15034637	Washer	1
6	15034631	Centre Stem	1
7	1260/8	Pawl	4
8	1260/7	Pawl Spring	4
9	15010005	Key	1
10	15034635	Ratchet Gear	1
11	15034636	Pawl Gear	1
12	15030004	Idler Spindle	1
13	15034633	Spindle	1
14	15034638	Washer	1

Spare Parts Kit
 Model No 34 ST
 Part No 19734600

#7347 \$6.50 LIST

Contents

- 1 x Key Pt No 1501005
- 4 x Spring Pt No 1260/7
- 4 x Pawl Pt No 1260/8
- 1 x Washer Pt No 15034637
- 1 x Washer Pt No 15034638

*Fixed Assembly

Fold out

JIB HALYARD

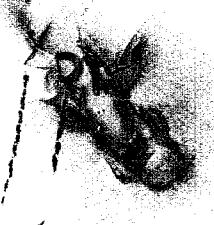

Lewmar
Self-tailing winches

NOTE: NO 40 1EA-MAINSHEET
ST 1EA-MAIN HALYARD

NOT IN BOOK
(NEW ADDITION TO LINE)

Model 42 ST

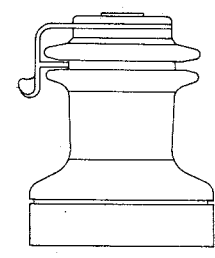

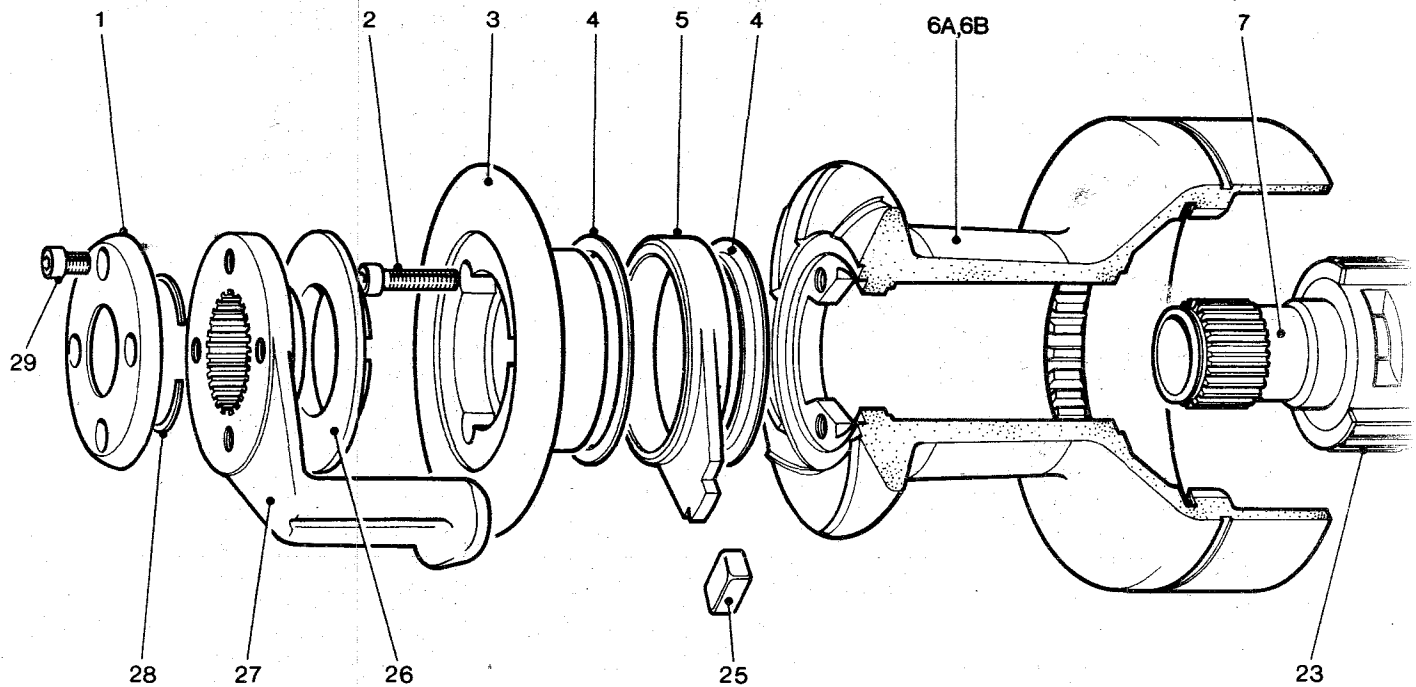
**Maintenance No. 42 ST**

A Release four allen screws (29) and remove top cap (1).

B Remove split collets (28).

C Lift off stripper arm (27).

D Remove flanged bush (26).

E Lift drum assembly (6) off centre stem assembly (7).

F Remove bearings (23), spacer (24) and washer (9).

G Remove key (8) from centre stem (7).

H Withdraw spindle (10) from centre stem (7).

I Release ratchet gear assemblies (20 & 21) (16 & 17) from centre stem (7) by removing retaining spindles (22 & 18).

J Remove drive gear (11) from retaining plate (12).

K Separate ratchet gear assembly (20 & 21).

L Separate ratchet gear assembly (16 & 17).

M Remove upper crown plate (3) by releasing three allen screws (2).

N Lift off stripper ring assembly (4 & 5 & 25).

O Clean thoroughly all parts

using kerosene (paraffin) or white spirit. Dry with a non-fluffy cloth.

P Replace stripper ring assembly (4 & 5 & 25) in drum (6).

Q Replace upper crown plate (3) with three allen screws (2).

R Check that pawls and springs (14 & 15) in pawl gear (21) are free and oil lightly.

S Lightly grease inner surface of ratchet gear (20) and fit pawl gear (21).

T Check that pawls and springs (14 & 15) in pawl gear (16) are free and oil lightly.

U Lightly grease inner surface of ratchet gear (17) and fit pawl gear (16).

V Lightly grease and replace drive gear (11) on retaining plate (12).

W Lightly grease and replace spindle (10) in centre stem (7).

X Fit key (8) in centre stem (7) ensuring it is located in groove on spindle (10).

Y Replace ratchet gear assembly (16 & 17) in centre stem (7) retaining it with spindle (18).

Z Check bush (19) in centre stem (7) and replace ratchet gear assembly (20 & 21) retaining it with spindle (22).

A.1. Replace washer (9), bearings (23) and spacer (24) on centre stem (7).

B.1. Lightly grease bearings and ratchet gear assemblies.

C.1. Lightly grease drum gear teeth. Replace drum assembly (6) on centre stem assembly (7).

D.1. Replace flanged bush (26) in upper crown plate (3).

E.1. Fit stripper arm (27) checking it is correctly located for rope lead and properly positioned on stripper ring (5).

F.1. Refit split collets (28).

G.1. Replace top cap (1). Fasten with four allen screws (24).

NOTE If retaining plate (12) has to be replaced, remove winch from boat and release circlip (13).

No 42ST

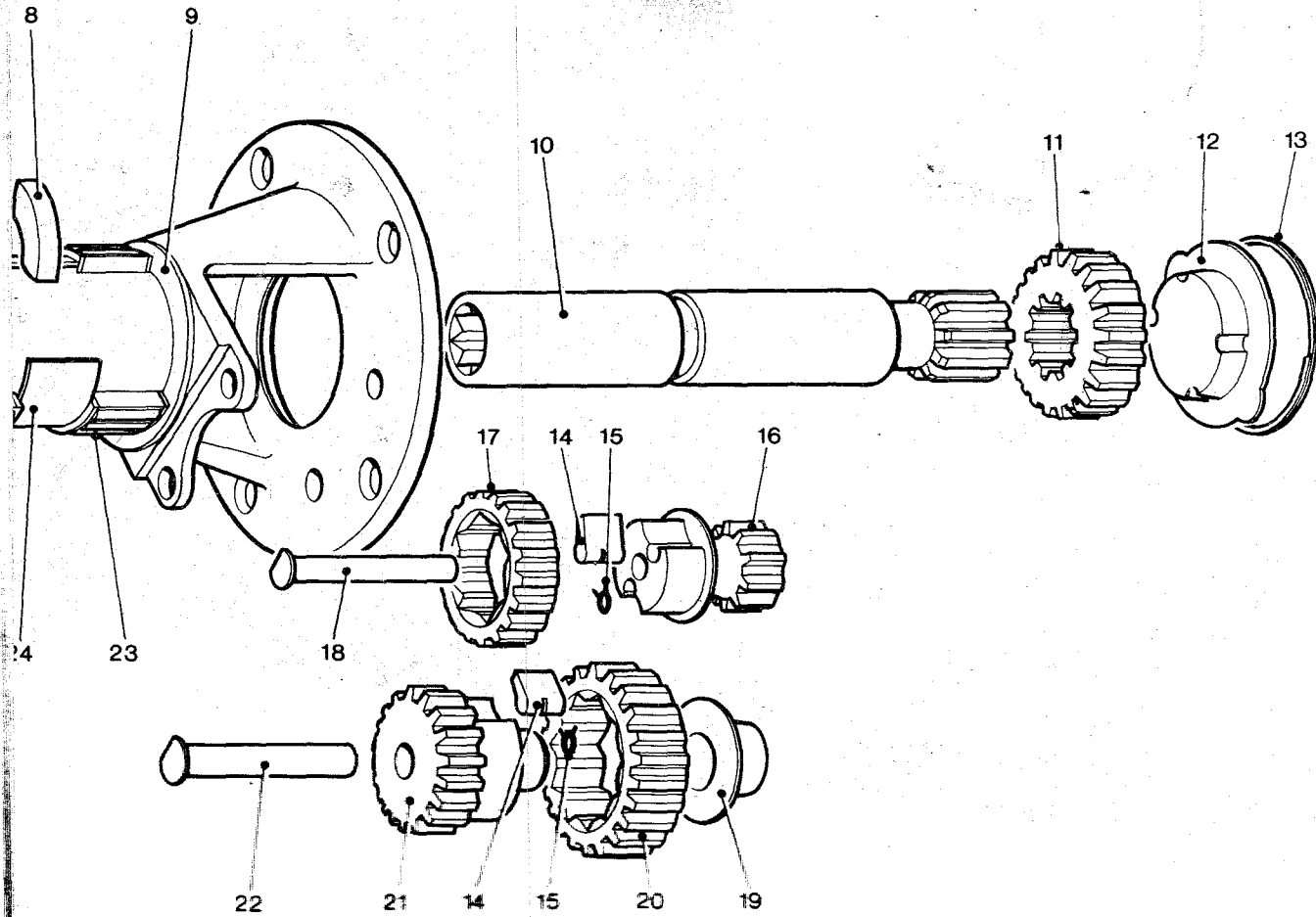

Parts list

Item Number	Part Number	Description	No. Off
1	15042607	Top Cap	1
2	B0721	Socket Head Cap Screw 1/4" x 20 UNC x 1" long	3
3	15042604	Upper Crown Plate	1
4	15042641	Stripper Ring Insert	2
5	15042606	Stripper Ring	1
6A	15042402	Drum (Bronze)	1
6B	15042502	Drum (Alum)	1
7	15042601	Centre Stem	1
8	15010005	Key	1
9	15042010	Washer	1
10	15042603	Spindle	1
11	15042009	Gear	1
12	15016007	Retaining Plate	1
13	B2085	Circlip, Spirolox	1
14	1260/8	Pawl	4
15	1260/7	Pawl Spring	4
16	15042008	Pawl Gear	1
17	15030005	Ratchet Gear	1

18	15042005	Gear Spindle	1
19	15042011	Retaining Bush	1
20	15042006	Ratchet Gear	1
21	15042007	Pawl Gear	1
22	15042004	Gear Spindle	1
23	15010007	Cage Assembly Bearing	2
24	15042012	Spacer	1
25	15042610	Cap	1
26	15042609	Flanged Bush	1
27	15042605	Stripper Arm	1
28	15042608	Split Collet	2
29	B0733	Socket Head Cap Screw 1/4" - 20 UNC x 3/8" long	4

Spare Parts Kit #7427 \$6.50
 Model No 42 ST
 Part No 19742100
 Contents
 1 x Key Part No 15010005
 4 x Spring Pt No 1260/7
 4 x Pawl Pt No 1260/8
 1 x Washer Pt No 15042010
 1 x Circlip Pt No B2075

Lewmar
Self-tailing winches

Model 44 ST

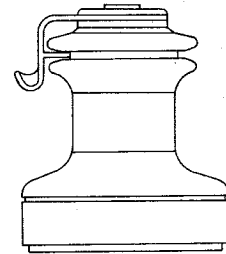

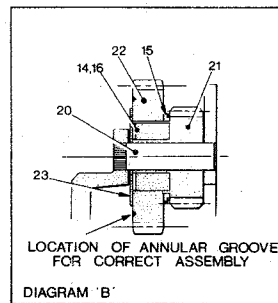
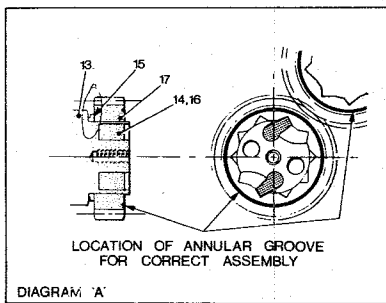
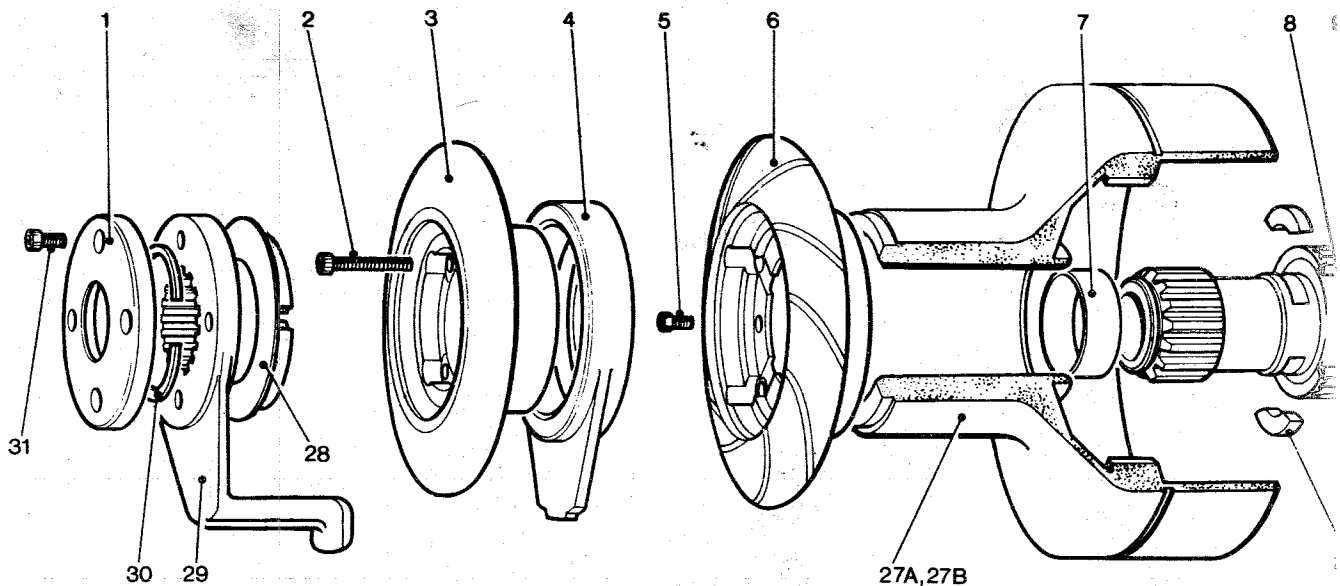

Parts list

Item Number	Part Number	Description	No. Off
1	15044639	Top Cap	1
2	B0729	Socket Head Cap Screw 1/4" x 20 UNC x 1 1/2" long	3
3	15044644	Upper Crown Plate	1
4	15044649	Stripper Ring	1
	15044641	Stripper Ring Insert	2
	15044642	Cap	1
5	B0723	Socket Head Cap Screw 1/4" x 20 UNC x 1/2" long	3
6	15044635	Lower Crown Plate	1
7	15044638	Collar	1
8	18044631	Centre Stem	1
9	15044121	Cage Assembly Bearing	2
10	15044116	Washer	1
11	1264/SA2	Cage Assembly Bearing	1
12	1300/21	Washer	1
13	15044633	Spindle	1

14	1260/8	Pawl	6
15	15025107	Spacer	2
16	1260/7	Pawl Spring	6
17	15016105	Ratchet Gear	2
18	15016107	Spindle End Cap	1
19	B0515	Countersunk Screw 1/4" x 20 UNC x 1/2" long.	1
20	15044108	Spindle	1
21	15025105	Pawl Gear	1
22	15041105	Ratchet Gear	1
23	15025106	Washer	2
24	15044109	Spindle	1
25	15044107	Output Gear	1
26	15040605	Key	2
27A	15044602	Drum, Stainless Steel	1
27B	15044502	Drum, Alloy	1
28	15044627	Flanged Bush	1
29	15044648	Stripper Arm	1
30	15044637	Split Collet	2
31	B0733	Socket Head Cap Screw 1/4" x 20 UNC x 3/8" long	4
32	15065115	Spacer	1

No 44ST

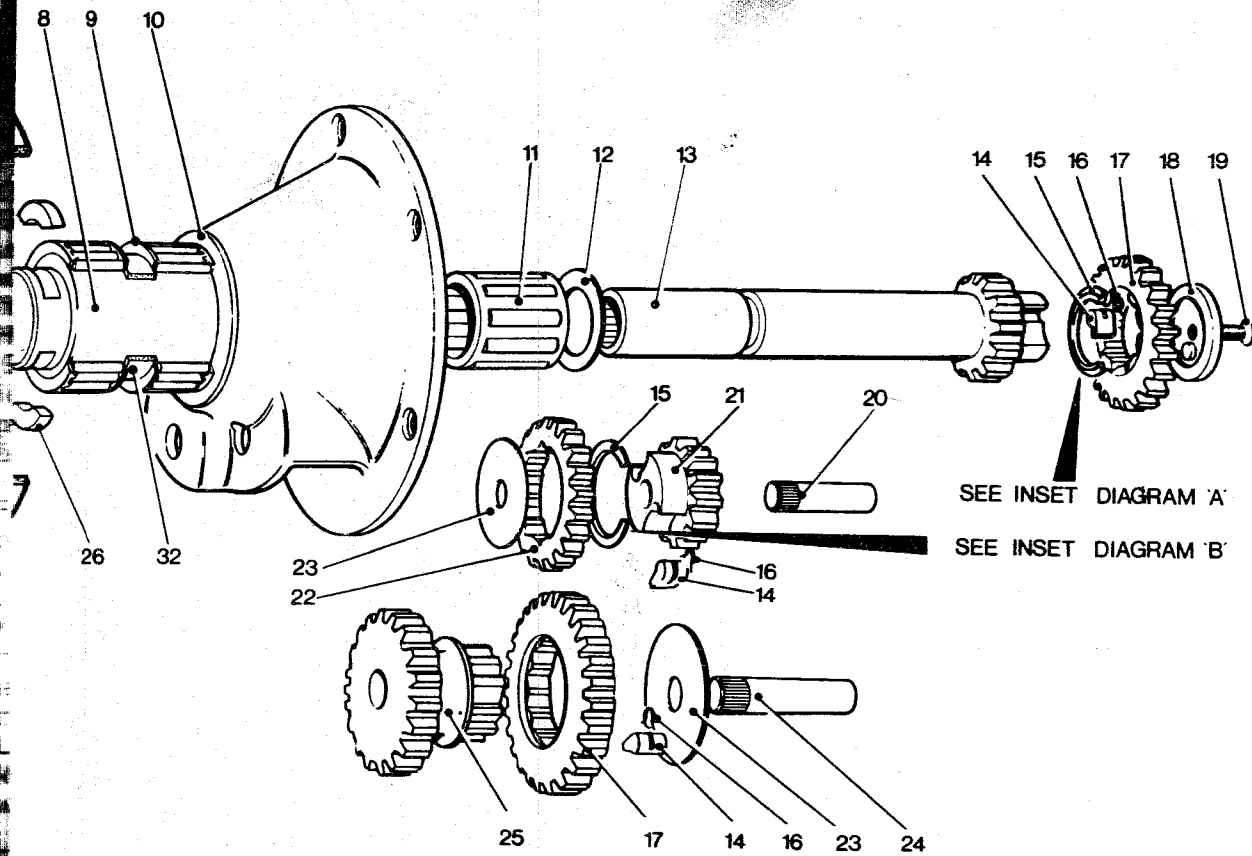

Spare Parts Kit

Model No 44 ST

Pt No 19744600

Contents

- 1 x Washer Pt No 15044116
- 2 x Washer Pt No 15025106
- 1 x Washer Pt No 1300/21
- 2 x Spacer Pt No 15025107
- 2 x Key Pt No 15040605
- 6 x Pawl Spring Pt No 1260/7
- 6 x Pawl Pt No 1260/8

Routine Maintenance No. 44 ST

- A** Release four allen screws (31) and remove top cap (1).
B Remove split collets (30).
C Lift off stripper arm (29).
D Remove flanged bush (28).
E Lift drum assembly (27) off centre stem assembly (8).
F Remove bearings (9), spacer (32) and washer (10).
G Clean thoroughly all parts using kerosene (paraffin) or white spirit. Dry with a non-fluffy cloth.
H Replace washer (10) bearings (9) and spacer (32) and grease lightly. Grease lightly ratchet gear assemblies (25 & 17) (22 & 21).
I Lightly grease drum gear teeth. Replace drum assembly (27) on centre stem assembly (8).
J Replace flanged bush (28) in upper crown plate (3).
K Fit stripper arm (29) checking it is correctly located for rope head and properly positioned on stripper ring (4).
L Refit split collets (30).
M Replace top cap (1). Fasten with four allen screws (31).

Full Annual Service

- To service completely, the winch must be removed from the boat, releasing all six countersunk screws which secure the centre stem.
- N** Remove the drum/stripper assembly as in **A - F** above.
O Remove centre stem (8) from boat.
P Remove key retaining ring (7).
Q Remove keys (26) from centre stem (8).
R Withdraw spindle assembly (13) from centre stem (8), complete with washer (12).
S Release screw (19) and remove cap (18) from spindle (13).
T Lift off ratchet gear (17).
U Firmly support the centre stem assembly (8) upside down ensuring that the lower exits of the bearing spindles (20 & 24) are not covered.
V Using a flat-ended drift, tap out bearing spindles (20 & 24) **DOWNWARDS**.
W Remove ratchet gear assemblies and washers.
X Separate ratchet gear assembly (25 & 17).
Y Separate ratchet gear assembly (21 & 22).
Z Remove bearing (11) from centre stem (8).

- A.1.** Remove upper crown plate (3) by releasing three allen screws (2).
B.1. Lift off stripper ring assembly (4)

- C.1.** Release lower crown plate (6) by removing three allen screws (5).
D.1. Clean thoroughly all parts using kerosene (paraffin) or white spirit. Dry with a non-fluffy cloth.
E.1. Replace lower crown plate (6) retaining it with three allen screws (5).
F.1. Replace stripper ring as assembly (4) in lower crown plate (6).
G.1. Replace upper crown plate (3) with three allen screws (2).
H.1. Replace bearing (11) in centre stem (8) and lightly grease.
I.1. Check that pawls and springs (14 & 16) in spindle (13) are free and oil lightly.
J.1. Lightly grease inner surface of ratchet gear (17) and fit to spindle (13) ensuring correct location of pawls (14) as per inset detailed diagram A.
K.1. Fit cap (18) with retaining screw (19) to spindle (13).
L.1. Fit washer (12) to spindle (13).
M.1. Lightly grease spindle (13) and replace it in centre stem (8).
N.1. Fit keys (26) in centre stem (8) ensuring that they are located in groove on spindle (13).
O.1. Replace key retaining ring (7) on centre stem (8).
P.1. Check that pawls and springs (14 & 16) in pawl gear (25) are free and oil lightly.
Q.1. Lightly grease inner surface of ratchet gear (17) and fit pawl gear (25).
R.1. Check that pawls and springs (14 & 16) in pawl gear (21) are free and oil lightly.
S.1. Lightly grease inner surface of ratchet gear (22) and fit pawl gear (21) ensuring correct assembly as per inset detailed diagram B.
T.1. Replace ratchet gear assembly (21 & 22) with washer (23) in centre stem (8) ensuring that ratchet gear (22) is at the top. Replace bearing spindle (20) driving home with flat-ended drift.
U.1. Replace ratchet gear assembly (17 & 25) with washer (23) in centre stem (8) ensuring that ratchet gear (17) is at the bottom. Replace bearing spindle (24) driving home with flat-ended drift.
V.1. Lightly grease both ratchet gear assemblies.
W.1. Refasten centre stem assembly (8) to boat.
X.1. Reassemble winch as in **H - M** above.

Fold out

Lewmar
Self-tailing winches

Model 48 ST

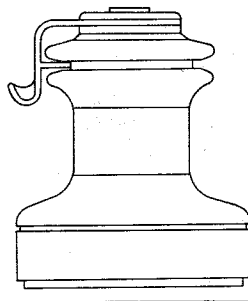

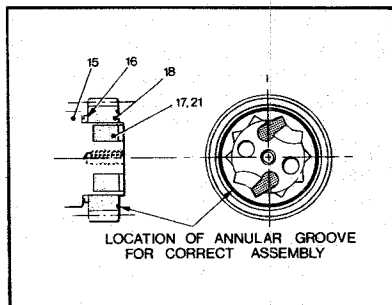
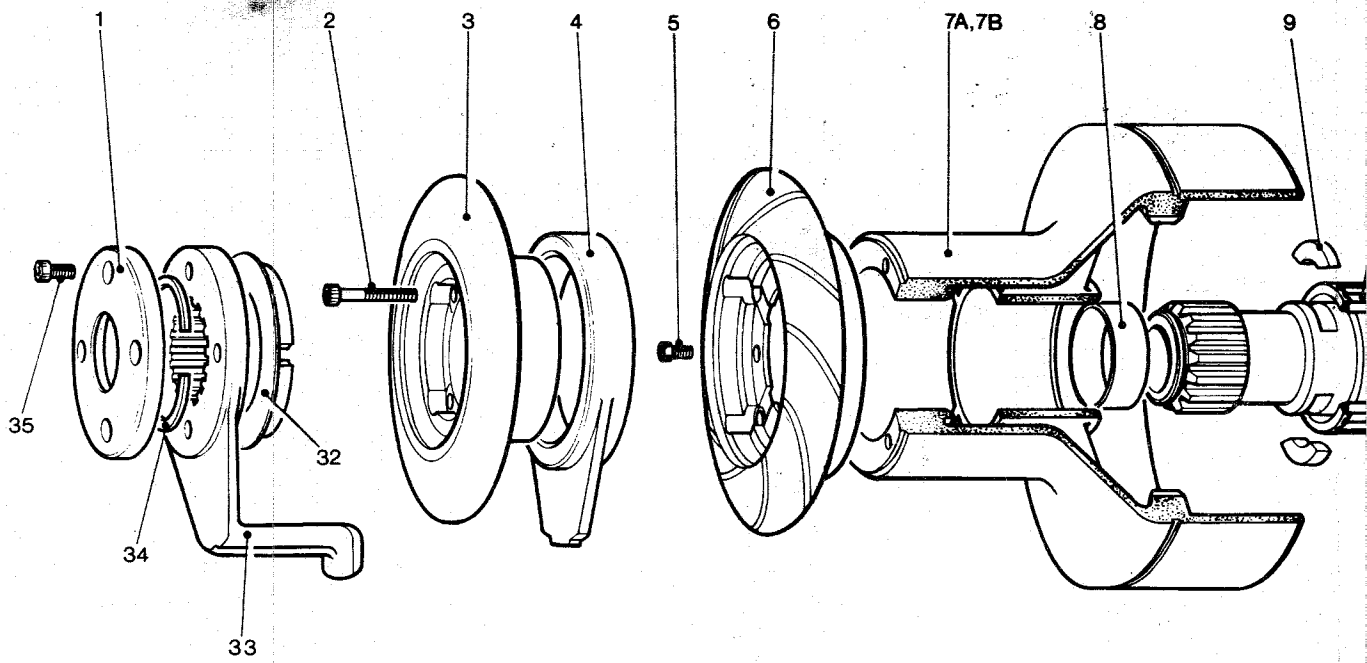

Parts list

Item Number	Part Number	Description	No. Off.
1	15044639	Top Cap	1
2	B0729	Socket Head Cap Screw 1/4" x 20 UNC x 1 1/2" long	3
3	15048644	Upper Crown Plate	1
4	15048649	Stripper Ring	1
	15048641	Stripper Ring Insert	2
	15044642	Cap	1
5	B0723	Skt. Hd. Cap Screw 1/4" - 20 UNC x 1 1/2" long	3
6	15048635	Lower Crown Plate	1
7A	15048602	Drum, Stainless Steel	1
7B	15048502	Drum, Alloy	1
8	15044638	Collar	1
9	15040605	Key	2
10	15044121	Cage Assembly Bearing	3
11	18048631	Centre Stem	1
12	15044116	Washer	1

13	1264/SA2	Cage Assembly Bearing	1
14	1300/21	Washer	1
15	15048633	Spindle	1
16	15025107	Spacer	1
17	1260/7	Pawl Spring	6
18	15048104	Ratchet Gear	1
19	15016107	Spindle End Cap	1
20	B0515	Countersunk Screw 1/4" x 20 UNC x 1/2" long	1
21	1260/8	Pawl	2
22	1300/10	Spindle	1
23	1300/22	Washer	2
24	1300/SA2	Cage Assembly Bearing	3
25	1300/8	Pawl Gear	1
26	1264/8	Pawl	4
27	1300/7	Ratchet Gear	1
28	1264/7	Washer	2
29	1300/9	Spindle	1
30	1300/5	Ratchet Gear	1
31	1300/6	Pawl Gear	1
32	15044627	Flanged Bush	1
33	15048648	Stripper Arm	1
34	15044637	Split Collet	2

No 48ST

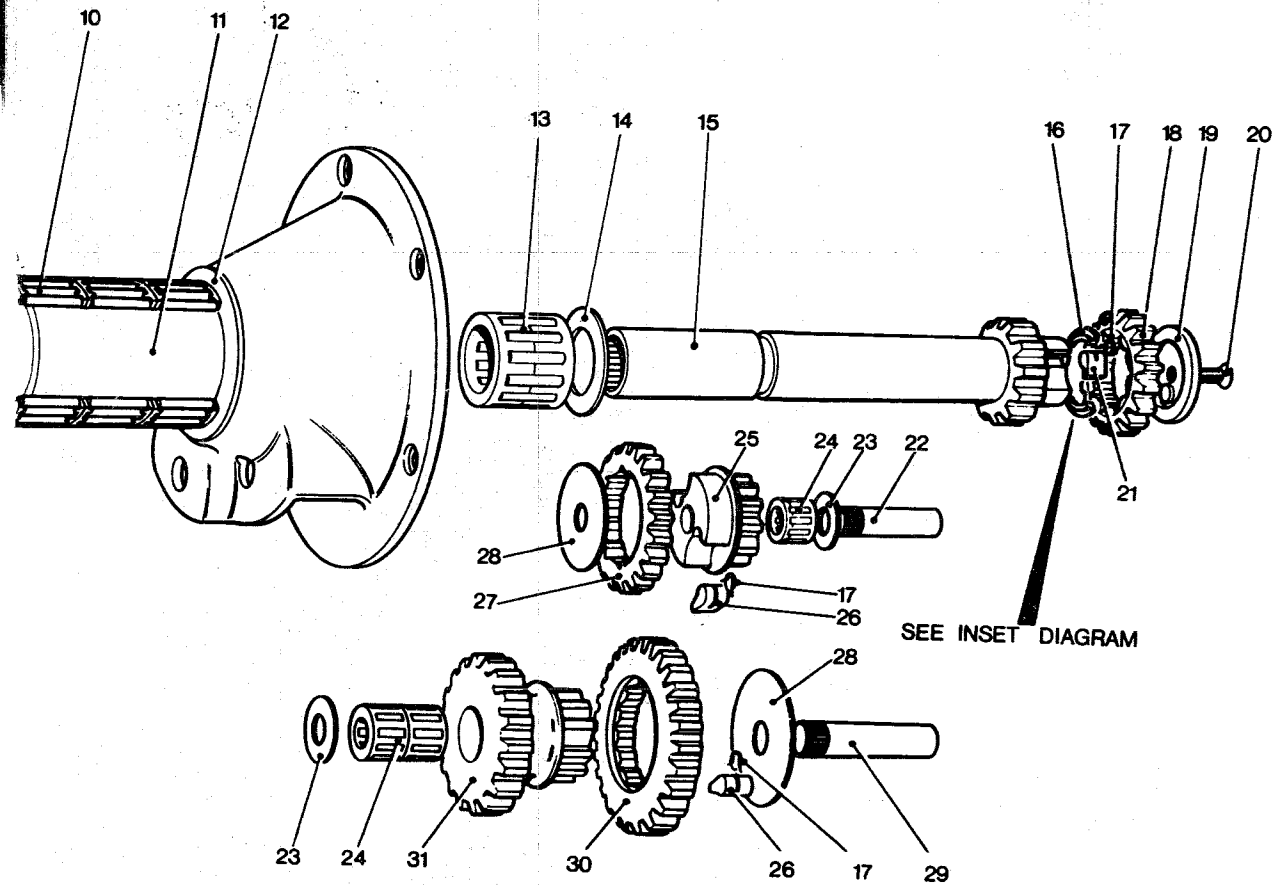

35	B0733	Socket Head Cap Screw 1/4" x 20 UNC x 3/8" long	4
----	-------	---	---

Spare Parts Kit

Model No 48 ST

Pt No 19748600

Contents

- 1 x Washer Pt No 15044116
- 2 x Washer Pt No 1264/7
- 1 x Washer Pt No 1300/21
- 2 x Washer Pt No 1300/22
- 2 x Key Pt No 15040605
- 6 x Pawl Spring Pt No 1260/7
- 2 x Pawl Pt No 1260/8
- 4 x Pawl Pt No 1264/8

Routine Maintenance No. 48 ST

A Release four allen screws (35) and remove top cap (1).

B Remove split collets (34).

C Lift off stripper arm (33).

D Remove flanged bush (32).

E Lift drum assembly (7) off centre stem assembly (11).

F Remove bearings (10) and washer (12).

G Clean thoroughly all parts using kerosene (paraffin) or white spirit. Dry with a non-fluffy cloth.

H Replace washer (12) and bearings (10) and grease lightly.

Grease lightly ratchet gear assemblies (30 & 31) (25 & 27).

I Lightly grease drum gear teeth. Replace drum assembly (7) on centre stem assembly (11).

J Replace flanged bush (32) in upper crown plate (3).

K Fit stripper arm (33) checking it is correctly located for rope lead and properly positioned on stripper ring (4).

L Refit split collets (34).

M Replace top cap (1). Fasten with four allen screws (35).

Full Annual Service

To service completely, the winch must be removed from the boat, releasing all six countersunk screws which secure the centre stem.

N Remove the drum/stripper assembly as in A – F above.

O Remove centre stem (11) from boat.

P Remove key retaining ring (8).

Q Remove keys (9) from centre stem (11).

R Withdraw spindle assembly (15) from centre stem (11), complete with washer (14).

S Release screw (20) removing cap (19) from spindle (15).

T Lift off ratchet gear (18).

U Firmly support the centre stem assembly (11) upside down ensuring that the lower exits of the bearing spindles (22 & 29) are not covered.

V Using a flat-ended drift, tap out bearing spindles (22 & 29) DOWNWARDS.

W Remove ratchet gear assemblies and washers.

X Separate ratchet gear assembly (30 & 31) and remove bearings (24).

Y Separate ratchet gear assembly (25 & 27) and remove bearing (24).

Z Remove bearing (13) from centre stem (11).

A1 Remove upper crown plate (3) by releasing three allen screws (2).

B1 Lift off stripper ring assembly (4).

C1 Release lower crown plate (6) by removing three allen screws (5).

D1 Clean thoroughly all parts using kerosene (paraffin) or white spirit. Dry with a non-fluffy cloth.

E1 Replace lower crown plate (6) retaining it with three allen screws (5).

F1 Replace stripper ring assembly (4) in lower crown plate (6).

G1 Replace upper crown plate (3) with three allen screws (2).

H1 Replace bearing (13) in centre stem (11) and lightly grease.

I1 Check that pawls and springs (21 & 17) in spindle (15) are free and oil lightly.

J1 Lightly grease inner surface of ratchet gear (18) and fit to spindle (15) ensuring correct location of pawls (21) as per inset detailed diagram.

K1 Fit cap (19) with retaining screw (20) to spindle (15).

L1 Fit washer (14) to spindle (15).

M1 Lightly grease spindle (15) and replace it in centre stem (11).

N1 Fit keys (9) in centre stem (11) ensuring that they are located in groove on spindle (15).

O1 Replace key retaining ring (8) on centre stem (11).

P1 Check that pawls and springs (26 & 17) in pawl gear (31) are free and oil lightly.

Q1 Lightly grease inner surface of ratchet gear (30) and fit pawl gear (31). Lightly grease bearings (24) and replace in pawl gear (31).

R1 Check that pawls and springs (26 & 17) in pawl gear (25) are free and oil lightly.

S1 Lightly grease inner surface of ratchet gear (27) and fit pawl gear (25). Lightly grease bearing (24) and replace in pawl gear (25).

T1 Replace ratchet gear assembly (25 & 27) with washers (28 & 23) in centre stem (11) ensuring that ratchet gear (27) is at the top. Replace bearing spindle (22), driving home with flat-ended drift.

U1 Replace ratchet gear assembly (30 & 31) with washers (28 & 23) in centre stem (11) ensuring that ratchet gear (30) is at the bottom. Replace bearing spindle (29), driving home with flat-ended drift.

V1 Lightly grease both ratchet gear assemblies.

W1 Refasten centre stem assembly (11) to boat.

X1 Reassemble winch as in H–M above.

TOPSA.PP SHEETS - PRIMARIES

2 EA

Fold out

Lewmar

Self-tailing winches

Model 55 ST

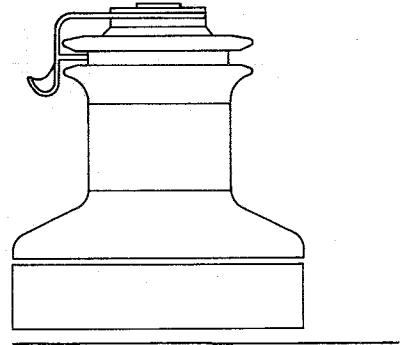

Lewmar

PRIMARIES 2-EA. Self-tailing winches

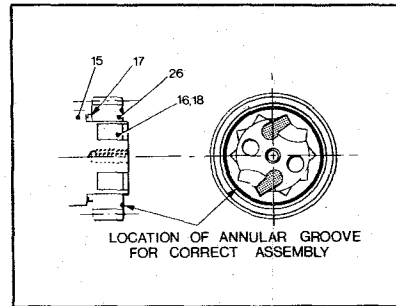
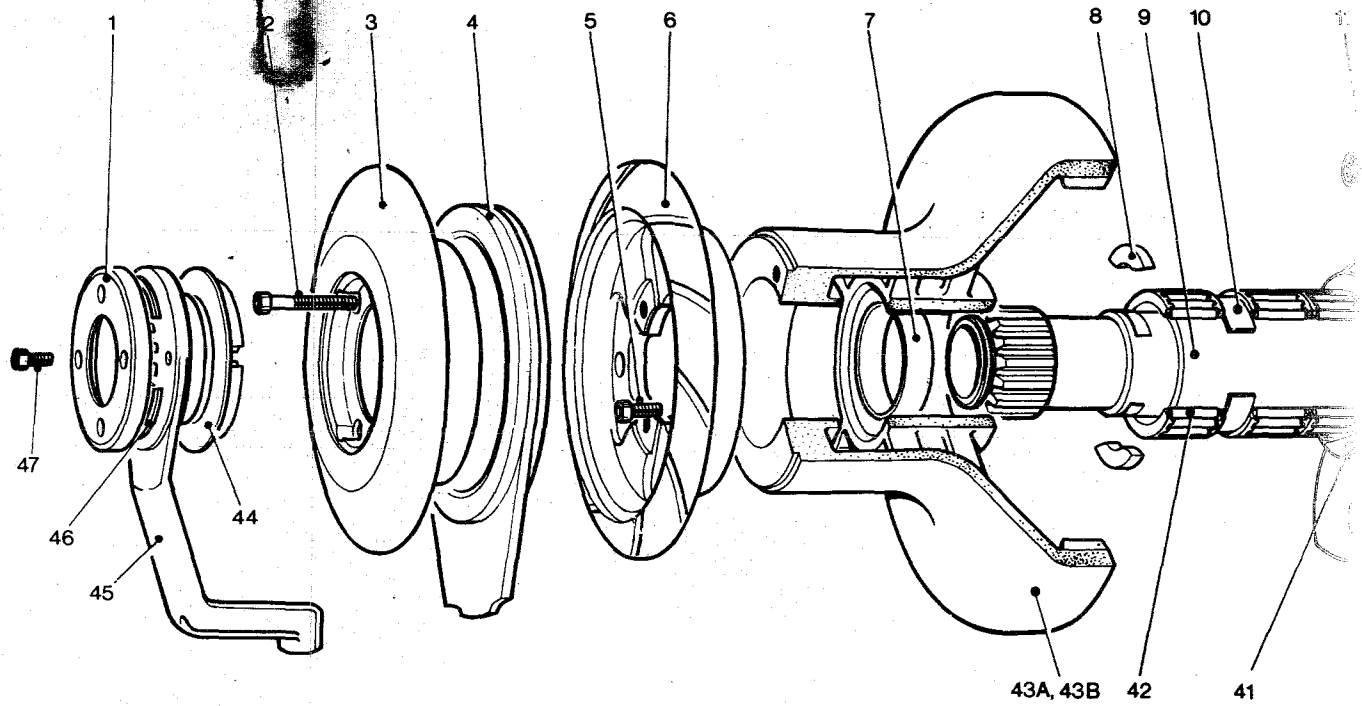

Parts list

Item Number	Part Number	Description	No. Off.
1	15044639	Top Cap	1
2	B0731	Socket Head Cap Screw 1/4" x 20 UNC x 1 3/4" long	3
3	15055644	Upper Crown Plate	1
4	15055649	Stripper Ring	1
	15055641	Stripper Ring Insert	2
	15044642	Cap	1
5	B0709	Skt. Hd. Cap Screw 1/4" - 20 UNC x 1/2" long.	3
6	15055645	Lower Crown Plate	1
7	15044638	Collar	1
8	15040605	Key	2
9	18055631	Centre Stem	1
10	15048105	Spacer	1
11	B0714	Socket Head Cap Screw 3/8" x 16 UNC x 3/4" long	3
12	B2079	Circlip, Spirolox	1
13	1264/SA2	Cage Assembly Bearing	1
14	1300/21	Washer	1

15	15055603	Spindle	1
16	1260/8	Pawl	2
17	15025107	Spacer	1
18	1260/7	Pawl Spring	6
19	15016107	Spindle End Cap	1
20	15055204	Base	1
21	1301/22	Dowel	1
22	1301/17	Dowel	2
23	B1506	Spirol Pin	2
24	15055105	Bridge Piece	1
25	B0515	Countersunk Screw 1/4" x 20 UNC x 1/2" long	1
26	15048104	Ratchet Gear	1
27	1301/10	Spindle	1
28	1301/11	Washer	1
29	1264/8	Pawl	4
30	1301/7	Pawl Gear	1
31	B2077	Circlip	1
32	1301/6	Ratchet Gear	1
33	1301/SA2	Cage Assembly Bearing	3
34	1301/19	Washer	1
35	1264/6	Spindle	1
36	1300/22	Washer	1
37	1300/SA2	Cage Assembly Bearing	1
38	1300/8	Pawl Gear	1
39	1300/7	Ratchet Gear	1

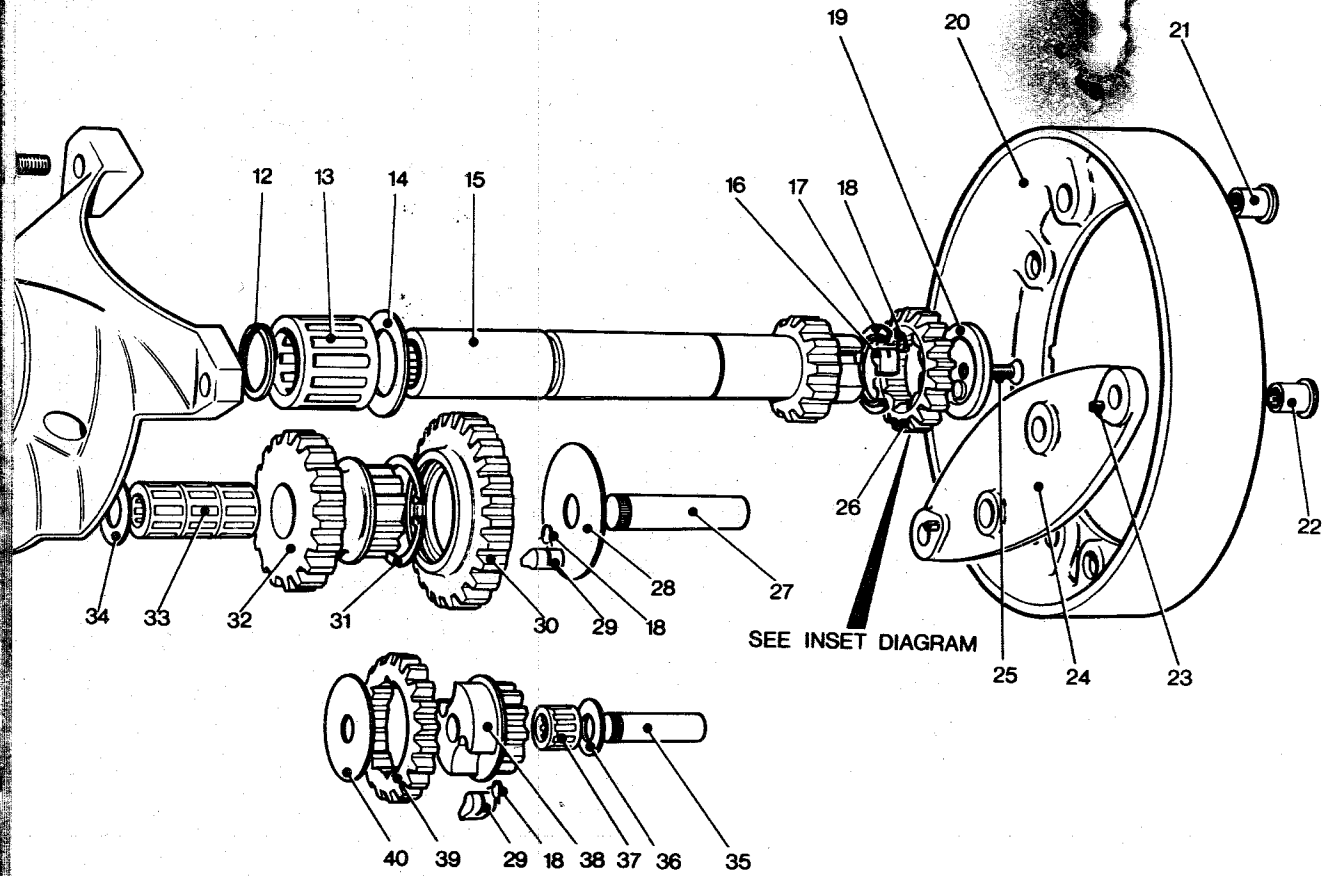

40	15055119	Washer	1
41	15044116	Washer	1
42	15044121	Cage Assembly	
		Bearing	3
43A	15055602	Drum, Stainless Steel	1
43B	15055502	Drum, Alloy	1
44	15044627	Flanged Bush	1
45	15055648	Stripper Arm	1
46	15044637	Split Collet	2
47	B0733	Socket Head Cap Screw 1/4" x 20 UNC x 3/8" long	4

Spare Parts Kit
 Model No 55 ST
 Pt No 19755600
 Contents
 1 x Washer Pt No 15044116
 1 x Washer Pt No 15055119
 1 x Washer Pt No 1300/21
 1 x Washer Pt No 1300/22
 1 x Washer Pt No 1301/11
 1 x Washer Pt No 1301/19
 1 x Spacer Pt No 15025107
 2 x Key Pt No 15040605
 1 x Circlip Pt No B2077
 1 x Circlip Pt No B2079
 6 x Pawl Spring Pt No 1260/7
 2 x Pawl Pt No 1260/8
 4 x Pawl Pt No 1264/8

7557 \$9.00 LIST

Routine Maintenance No. 55 ST

- A Release four allen screws (47) and remove top cap (1).
- B Remove split collets (46).
- C Lift off stripper arm (45).
- D Remove flanged bush (44).
- E Lift drum assembly (43) off centre stem assembly (9).
- F Remove bearings (42), spacer (10) and washer (41).
- G Clean thoroughly all parts using kerosene (paraffin) or white spirit. Dry with a non-fluffy cloth.
- H Replace washer (41), bearings (42) and spacer (10) on centre stem (9) and grease lightly. Grease lightly ratchet gear assemblies (38 & 39) (30 & 32).
- I Lightly grease drum gear teeth. Replace drum assembly (43) on centre stem assembly (9).
- J Replace flanged bush (44) in upper crown plate (3).
- K Fit stripper arm (45) checking it is correctly located for rope lead and properly positioned on stripper ring (4).
- L Refit split collets (46).
- M Replace top cap (1). Fasten with four allen screws (47).

Full Annual Service

To service completely, the winch must be removed from the boat.

- N Remove the drum/stripper assembly as in A - F above.
- O Remove centre stem (9) from base plate (20) by releasing three allen screws (11).
- P Tap off bridge piece (24).
- Q Remove key retaining ring (7).
- R Remove keys (8) from centre stem (9).
- S Withdraw spindle assembly (15) and ratchet gear assemblies (38 & 39) (30 & 32) from centre stem (9).
- T Release screw (25) and remove cap (19) from spindle (15).
- U Lift off ratchet gear (26).
- V Remove bearing (13) and washer (14) from spindle (15) by removing circlip (12).
- W Remove bearings (33) from ratchet gear assembly (30 & 32). Separate pawl gear (32) from ratchet gear (30) by removing circlip (31).
- X Separate ratchet gear assembly (38 & 39). Remove bearing (37) from pawl gear (38).
- Y Remove upper crown plate (3) by releasing three allen screws (2).
- Z Lift off stripper ring assembly (4).

- A1 Release lower crown plate (6) by removing three allen screws (5).
- B1 Clean thoroughly all parts using kerosene (paraffin) or white spirit. Dry with a non-fluffy cloth.
- C1 Replace lower crown plate (6) retaining it with three allen screws (5).
- D1 Replace stripper ring assembly (4) in lower crown plate (6).
- E1 Replace upper crown plate (3) with three allen screws (2).
- F1 Check that pawls and springs (16 & 18) in spindle (15) are free and oil lightly.

- G1 Lightly grease inner surface of ratchet gear (26) and fit to spindle (15) ensuring correct location of pawls (16) as per inset detailed diagram.
- H1 Fit cap (19) with retaining screw (25) to spindle (15).
- I1 Fit washer (14) and bearing (13) to spindle (15) retaining them with circlip (12).
- J1 Lightly grease spindle assembly.
- K1 Check that pawls and springs (29 & 18) in pawl gear (32) are free and oil lightly.
- L1 Lightly grease inner surface of ratchet gear (30) and fit pawl gear (32) retaining it with circlip (31). Lightly grease bearings (33) and replace in pawl gear (32).
- M1 Check that pawls and springs (29 & 18) in pawl gear (38) are free and oil lightly.
- N1 Lightly grease inner surface of ratchet gear (39) and fit pawl gear (38). Lightly grease bearing (37) and replace in pawl gear (38).
- O1 Replace washer (40) on spindle (35).
- P1 Replace washer (34) on spindle (27).
- Q1 Replace spindle assembly (15) in centre stem (9) at the same time positioning ratchet gear assemblies (30 & 32) (38 & 39) on spindles (27 & 35).
- R1 Replace washer (28) on spindle (27).
- S1 Replace washer (36) on spindle (35).
- T1 Replace bridge piece (24) tapping into place with soft mallet.
- U1 Fit keys (8) in centre stem (9) ensuring that they are located in groove on spindle (15).
- V1 Replace key retaining ring (4) on centre stem (9).
- W1 Lightly grease both ratchet gear assemblies.

- X1 Replace centre stem assembly (9) in base (20) ensuring that bridge piece (24) is placed on longest part of locating bushes (22). Fasten with three allen screws (11).
- Y1 Reassemble winch as in H - M above.

not in assembly

Routine Maintenance No. 65 ST

- A** Release four allen screws (46) and remove top cap (1).
- B** Remove split collets (45).
- C** Lift off stripper arm (44).
- D** Remove flanged bush (43).
- E** Lift drum assembly (7) off centre stem assembly (9).
- F** Remove bearings (10) and thrust bearing (41).
- G** Clean thoroughly all parts using kerosene (paraffin) or white spirit. Dry with a non-fluffy cloth.
- H** Replace thrust bearing (41) and bearings (10) on centre stem (9) and grease lightly. Grease Lightly ratchet gear assemblies (37 & 38) (29 & 31).
- I** Lightly grease drum gear teeth. Replace drum assembly (7) on centre stem assembly (9).
- J** Replace flanged bush (43) in upper crown plate (3).
- K** Fit stripper arm (44) checking it is correctly located for rope lead and properly positioned on stripper ring (4).
- L** Refit split collets (45).
- M** Replace top cap (1). Fasten with four allen screws (46).

Full Annual Service

To service completely, the winch must be removed from the boat.

- N** Remove the drum/stripper assembly as in A — F above.
- O** Remove centre stem (9) from base plate (24) by releasing six allen screws (11).
- P** Release three allen screws (12), spindle nut (25) and remove bridge piece (17).
- Q** Remove key retaining ring (8).
- R** Remove keys (42) from centre stem (9).
- S** Withdraw spindle assembly (15) with washer (14) and ratchet gear assemblies (37 & 38) (29 & 31) from centre stem (9).
- T** Release screw (22) and remove cap (21) from spindle (15).
- U** Lift off ratchet gear (20).
- V** Remove bearing (13) from centre stem (9).
- W** Remove bearings (36) from ratchet gear assembly (37 & 38). Separate pawl gear (37) from ratchet gear (38) by releasing screws (40) from retaining plate (39).
- X** Separate ratchet gear assembly (29 & 31). Remove bearings (32) from ratchet gear (31).
- Y** Remove upper crown plate (3) by releasing three allen screws (2).
- Z** Lift off stripper ring assembly (4).
- A1** Release lower crown plate (6) by removing three allen screws (5).

- B1** Clean thoroughly all parts using kerosene (paraffin) or white spirit. Dry with a non-fluffy cloth.
- C1** Replace lower crown plate (6) retaining it with three allen screws (5).
- D1** Replace stripper ring assembly (4) in lower crown plate (6).
- E1** Replace upper crown plate (3) with three allen screws (2).
- F1** Check that pawls and springs (23 & 19) in spindle (15) are free and oil lightly.
- G1** Lightly grease inner surface of ratchet gear (20) and fit to spindle (15) ensuring correct location of pawls (23) as per inset detailed diagram.
- H1** Fit cap (21) with retaining screw (22) to spindle (15).
- I1** Fit washer (14) to spindle (15) and lightly grease spindle assembly.
- J1** Lightly grease bearing (13) and replace in centre stem (9).
- K1** Check that pawls and springs (30 & 19) in pawl gear (29) are free and oil lightly.
- L1** Lightly grease outer surface of ratchet gear (31) and fit pawl gear (29). Lightly grease bearings (32) and replace in ratchet gear (31).
- M1** Check that pawls and springs (30 & 19) in pawl gear (37) are free and oil lightly.
- N1** Lightly grease inner surface of ratchet gear (38), fit pawl gear (37) and fasten retaining plate (39) with two screws (40). Lightly grease bearings (36) and replace in pawl gear (37).
- O1** Replace washer (28) on spindle (27).
- P1** Replace washer (35) on spindle (34).
- Q1** Replace ratchet gear assembly (37 & 38) on spindle (34).
- R1** Replace ratchet gear assembly (29 & 31) on spindle (27).
- S1** Replace spindle assembly (15) in centre stem (9).
- T1** Replace washer (33) on spindle (27).
- U1** Replace washer (35) on spindle (34).
- V1** Replace bridge piece (17) retaining it with spindle nut and washer (25 & 26) and three allen screws (12).
- W1** Fit keys (42) in centre stem (9) ensuring that they are located in groove on spindle (15).
- X1** Replace key retaining ring (8) on centre stem (9).
- Y1** Lightly grease both ratchet gear assemblies.
- Z1** Replace centre stem assembly (9) in base (24). Fasten with six allen screws (11).
- A2** Reassemble winch as in H — M above.

Fold out

Lewmar

Three speed
automatic grinders

Model 80

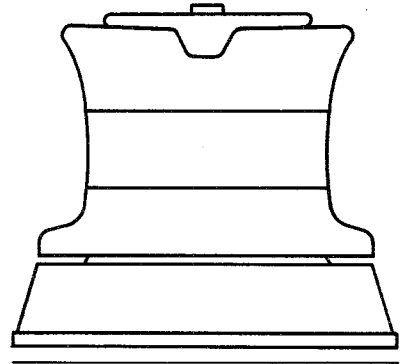

Lewmar

Three speed automatic grinders

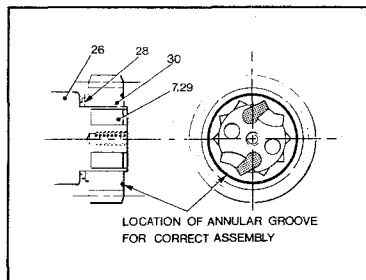
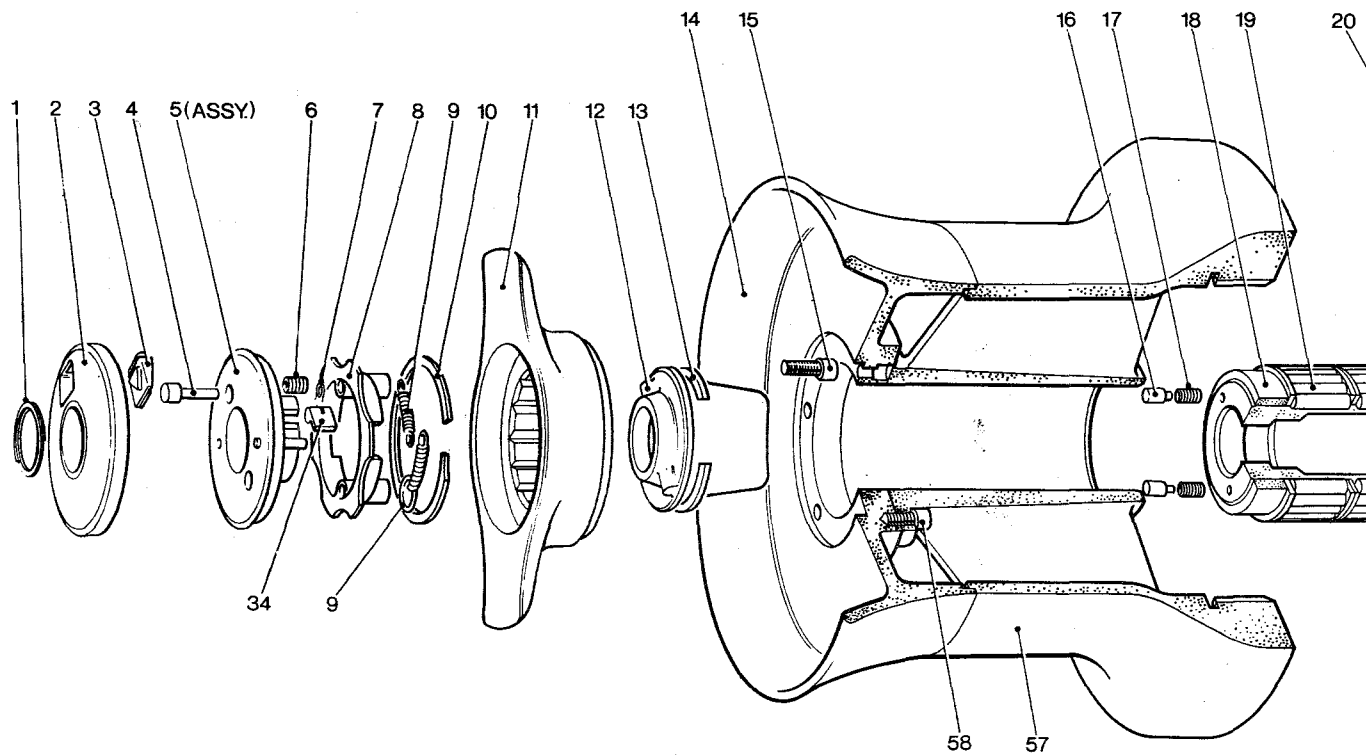

Parts list

Item Number	Part Number	Description	No. Off
1	B0275	Circlip, Spirolox	1
2	15080106	Top Cap Cover	1
3	15044114	Push Button	1
4	15044111	Plunger	1
5	15044104	Top Cap Assembly	1
6	15044112	Spring	1
7	1260/7	Pawl Spring	9
8	15044106	Closing Ring	1
9	15044113	Spring	2
10	B2083	Circlip, Spirolox	1
11	15080001	Cleat	1
12	15044105	Clutch Plate	1
13	15044118	Collet	2
14	15080004	Drum Top	1
15	B0730	Socket Head Cap Screw $\frac{5}{16}$ " x 18 UNC x $\frac{5}{8}$ " long	4
16	1300/24	Plunger	2
17	1300/20	Spring	2
18	15080005	Spacer	1
19	1301/SA3	Cage Assembly	4
20	B0698	Socket Head Cap Screw $\frac{5}{16}$ " x 18 UNC x $1\frac{1}{2}$ " long	3
21	B0714	Socket Head Cap Screw $\frac{3}{8}$ " x 16 UNC x $\frac{3}{4}$ " long	6

22	15044116	Drum Washer	1
23	15065201	Centre Stem	1
24	1264 SA2	Cage Assembly	1
25	1300 21	Washer	2
26	15065103	Spindle	1
27	15044119	Drive Pin	1
28	15025107	Spacer	1
29	1260 8	Pawl	4
30	15065116	Ratchet Gear	1
31	15336002	Dowel	2
32	15336003	Button	2
33	15080010	Dog Plate	1
34	15080013	Shoulder Screw $\frac{1}{4}$ " x 20 UNC	1
35	15080011	Splined Sleeve	1
36	15065111	Hollow Dowel	3
37	B2450	Washer	1
38	1287/SA1	Cage Assembly	1
39	15080012	Sleeve (bonded to Item 42)	1
40	B1009	Locknut $\frac{1}{2}$ " BSF	1
41	B1202	Washer	1
42	15080003	Base	1
43	15080009	Spindle	1
44	B2451	Washer	1
45	15080008	Pawl Gear	1
46	1264/8	Pawl	5
47	15080007	Output Gear	1

No. 80

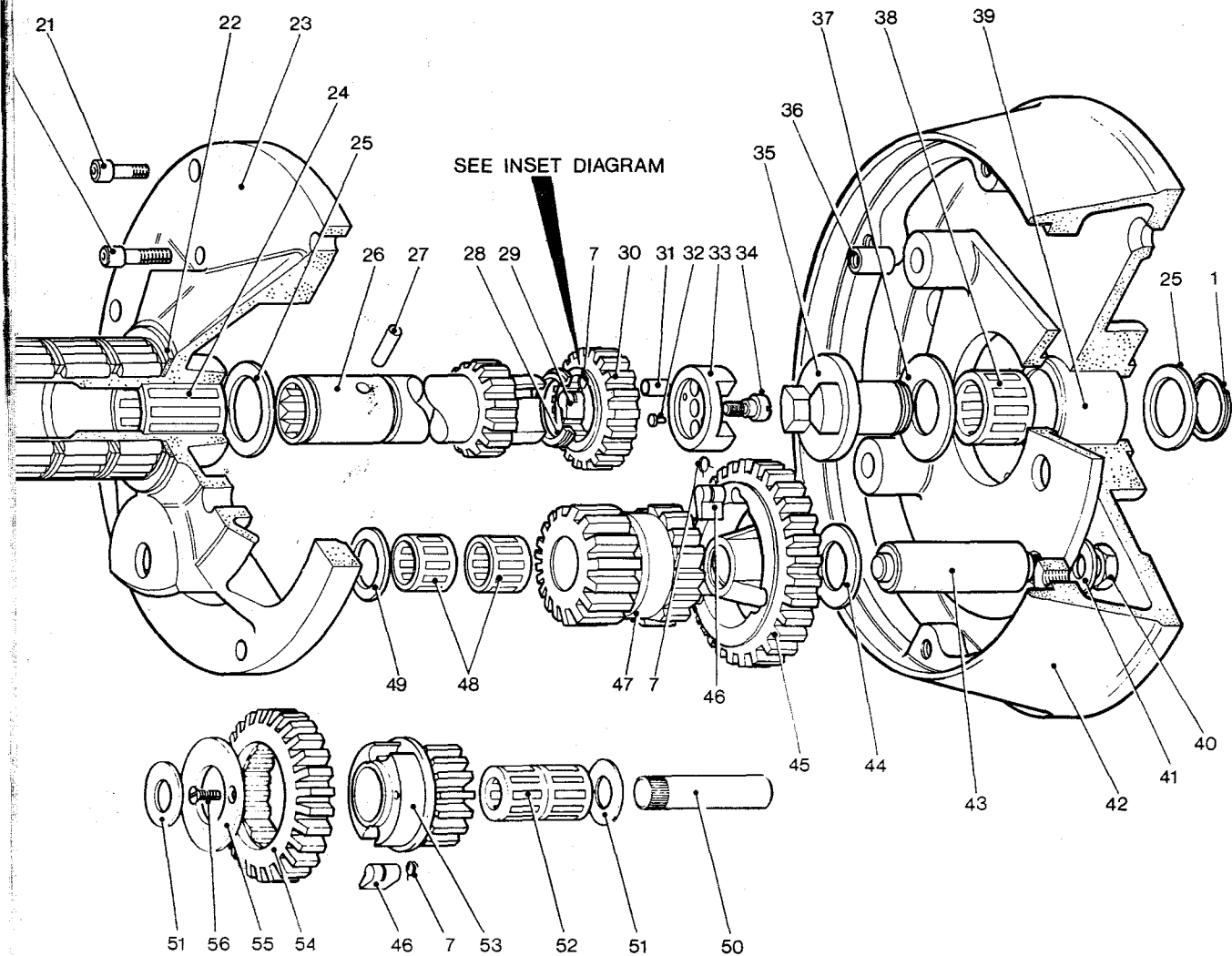

48	1337/SA2	Cage Assembly	2
49	15080014	Washer	1
50	1302/13	Spindle	1
51	1301/19	Washer	2
52	1301/SA2	Cage Assembly	2
53	1302/8	Pawl Gear	1
54	1302/7	Ratchet Gear	1
55	1302/17	Retaining Plate	1
56	B0511	Countersunk Screw 2BA x $\frac{3}{8}$ " long	2
57	15080002	Drum	1
58	B0719	Socket Head Cap Screw $\frac{5}{16}$ " x 18 UNC x $\frac{3}{4}$ " long	4

Spare Parts Kits

Model 80

Cat No 19765400

Contents

- 3 x Washer Pt No 1301/19
- 1 x Washer Pt No 1301/11
- 1 x Washer Pt No 15025107
- 4 x Pawl Pt No 1260/8
- 4 x Pawl Pt No 1264/8
- 8 x Spring Pt No 1260/7
- 2 x Plunger Pt No 15137203
- 2 x Spring Pt No 15137204
- 1 x Plunger Pt No 15044111
- 1 x Spring Pt No 15044112
- 1 x Pin Pt No 15044119
- 1 x Circlip Pt No B2077
- 1 x Circlip Pt No B2075
- 1 x Circlip Pt No B2083
- 2 x Spring Pt No 15044113

Maintenance No. 80

To ensure continuous trouble-free functioning, it is recommended that the winch be maintained as follows:

A Routine maintenance, at frequent intervals during constant use.

B Full service annually.

Routine Maintenance

A Using a small penknife or screwdriver, remove top circlip (1) from spindle (27).

B Lift off drum (14, 57), cleat (11) and top cap assembly.

C Wash off salt deposits and check that top cap mechanism and pawls (29) are functioning freely. If necessary, strip top cap by removing large circlip (10), disengaging two springs (9), depressing pawls and withdrawing closing ring (8), taking care not to lose plunger and compression spring assembly (4, 6). Clean, reassemble and lubricate with light oil.

D Lightly grease all remaining moving parts using Lewmar grease Part No 1385. Reassemble.

NOTE: When re-fitting top cap assembly ensure that pawls are closed, i.e. push button (3) is in raised position, and align drive slots in top cap (5) with drive pin (27) in spindle and push on.

Full Annual Service

E Lift off drum and top cap assembly as instructed in routine maintenance.

F Slide out cross mounted drive pin (27) and remove clutch plate (12), taking care not to lose plungers and springs (16, 17).

G Slide off drum cage assemblies (19), spacer (18) and washer (22).

H Remove six socket head cap screws 3/8" U.N.C. (21) securing centre stem (23) to base (42) and lift off centre stem assembly complete.

I Remove 1/2" BSF locknut (40) and washer (41) from underside of bridge piece.

J Remove three socket head cap screws 5/16" U.N.C. (20) securing bridge end piece to centre stem and gently tap off.

K Slide off gear assemblies from their spindles (43, 50) including cage assembly (48, 52).

L Prise out two collets (13) from spindle recess and carefully withdraw spindle assembly, cage assembly (24) and washer (25), from centre stem. Remove ratchet gear (30) from spindle by unscrewing shoulder screw 1/4" U.N.C. (34) and pulling off dog plate.

M Using a small penknife or screwdriver, remove circlip (1) and washer (25) from splined sleeve (35). Remove splined sleeve, washer (37) and cage assembly (38).

N Reassemble in the reverse sequence to above.

Fold out

Lewmar
Halliard Reel winches

Model 1 Mk I

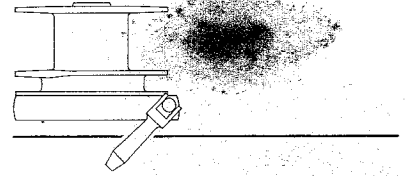

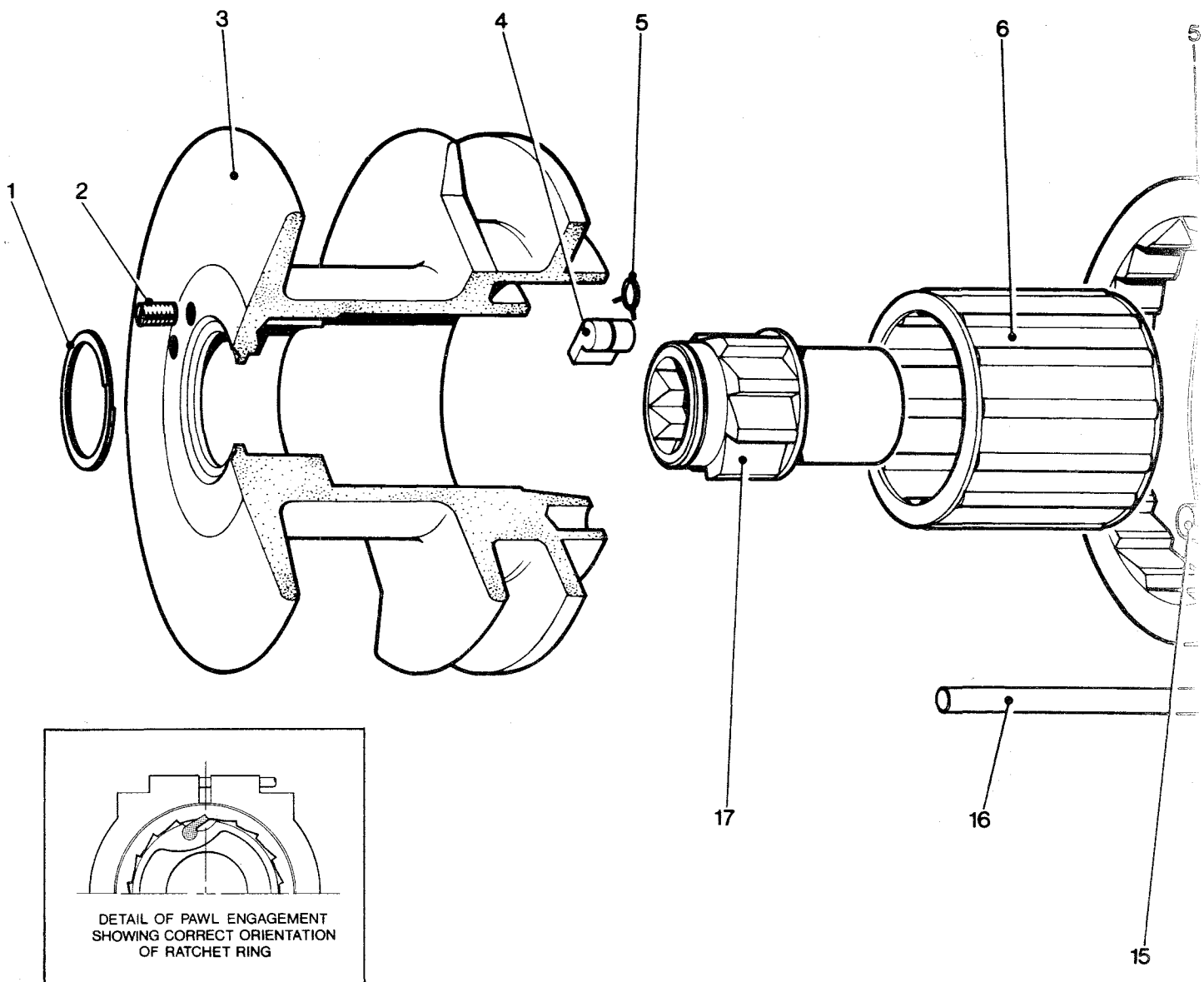
**Maintenance No 1 – Mark I**

A Remove halliard wire from drum (3) by releasing grub screws (2).

B Using a small screwdriver, remove circlip (1).

C Remove drum (3) from centre stem (13).

D Remove bearing (6) from centre stem (13).

E Remove brake strap (8) and ratchet ring (7) from centre stem (13).

F Unscrew locking arm (14) from brake strap (8) and check thread.

G Clean outer surface of ratchet ring (7) with a light abrasive.

H Clean thoroughly all parts using kerosene (paraffin) or white spirit. Dry with a non-fluffy cloth. Ensure that the outer surface of ratchet ring (7) and the inner surface of brake strap (8) are free from grease.

I Replace locking arm (14) in brake strap.

J Replace brake strap (8) on

centre stem (13) ensuring that it is correctly placed on location pin (12).

K Check that pawls and springs (4 & 5) in top and (15 & 5) in bottom of drum (3) are free and oil lightly.

L Place ratchet ring (7) on drum (3) ensuring correct location of pawls (15) in ratchet ring (7). See inset detailed drawing.

M Replace bearing (6) on centre stem (13) and lightly grease.

N Replace drum (3) and ratchet ring (7) on centre stem (13).

O Refit circlip (1) to spindle (17).

To remove spindle (17)

P Strip winch as detailed above (A – E).

Q Remove winch from boat.

R Remove spindle (17) from centre stem (13) by releasing screw (11) and retaining plate (9).

S Clean and lightly grease spindle (17).

T Replace spindle (17) in centre stem (13) locking with retaining

plate (9) and screw (11).

U Refasten winch to boat.

V Reassemble as detailed above (G – O).

No 1 Mk. I

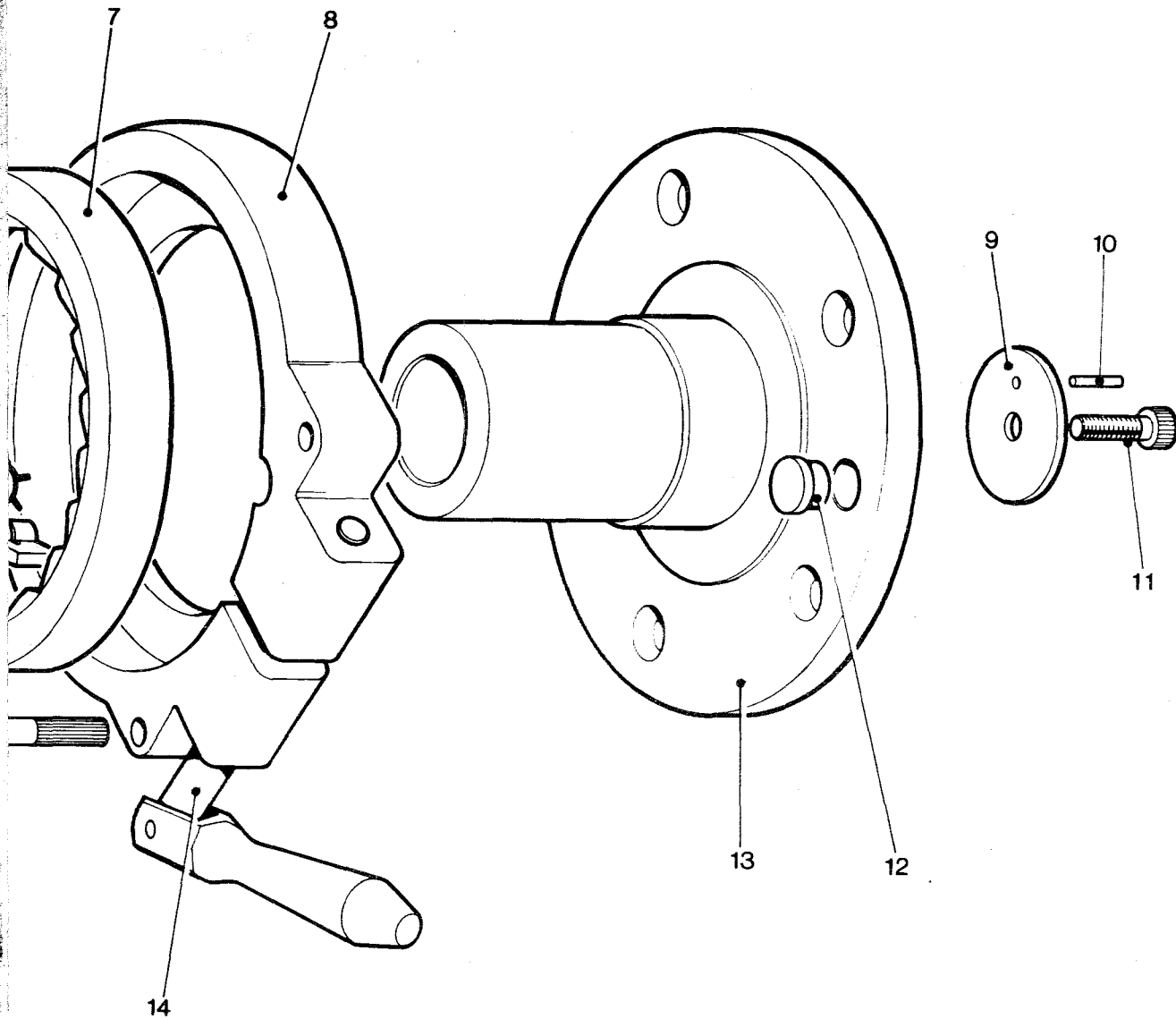

Parts list

Item Number	Part Number	Description	No. Off
1	B2080	Circlip, Spirolox	1
2	B0901	1/4" UNC Grub Screw x 3/8" long	2
3	15001002	Drum	1
4	1260/8	Pawl	2
5	1260/7	Pawl Spring	4
6	1266/SA1	Cage Assembly Bearing	1
7	15001004	Ratchet Ring	1
8	15001005	Brake Strap	1
9	15001007	Retaining Plate	1
10	B1502	Spirol Pin 3/32" dia x 7/16" long	1
11	B0776	1/4" x 20 UNC Socket Hd x 1/2" long	1
12	15001008	Locating Pin	1
13	15001001	Centre Stem	1

14	15001010	Brake Lever	} *	1
	15001011	Brake Screw		
	15001009	Handle Rivet		
15	15001012	Pawl		2
16	15001006	Guard Rod		2
17	15001003	Spindle		1

* Fixed Assembly

Spare Parts Kit

Halliard Reel No 1—Mark I

Cat No 19701400

Contents

- 2 x Pawl Pt No 15001012
- 1 x Tab Washer Pt No 1266/6
- 4 x Spring Pt No 1260/7
- 4 x Pawl Pt No 1260/8
- 2 x Grub Screw Pt No B0901
- 1 x Circlip Pt No B2076
- 1 x Circlip Pt No B2080
- 1 x 1/4" 20 UNC Socket Head x 1/2" long Pt No B0776

Fold out

Lewmar
Halliard Reel winches

Model 1 Mk II

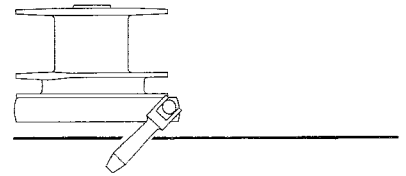

US
SP

Lewmar

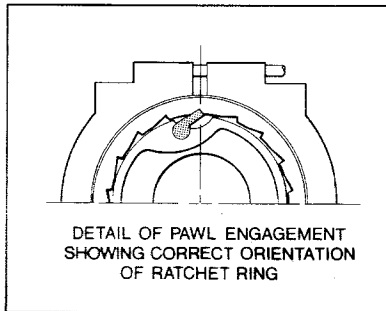
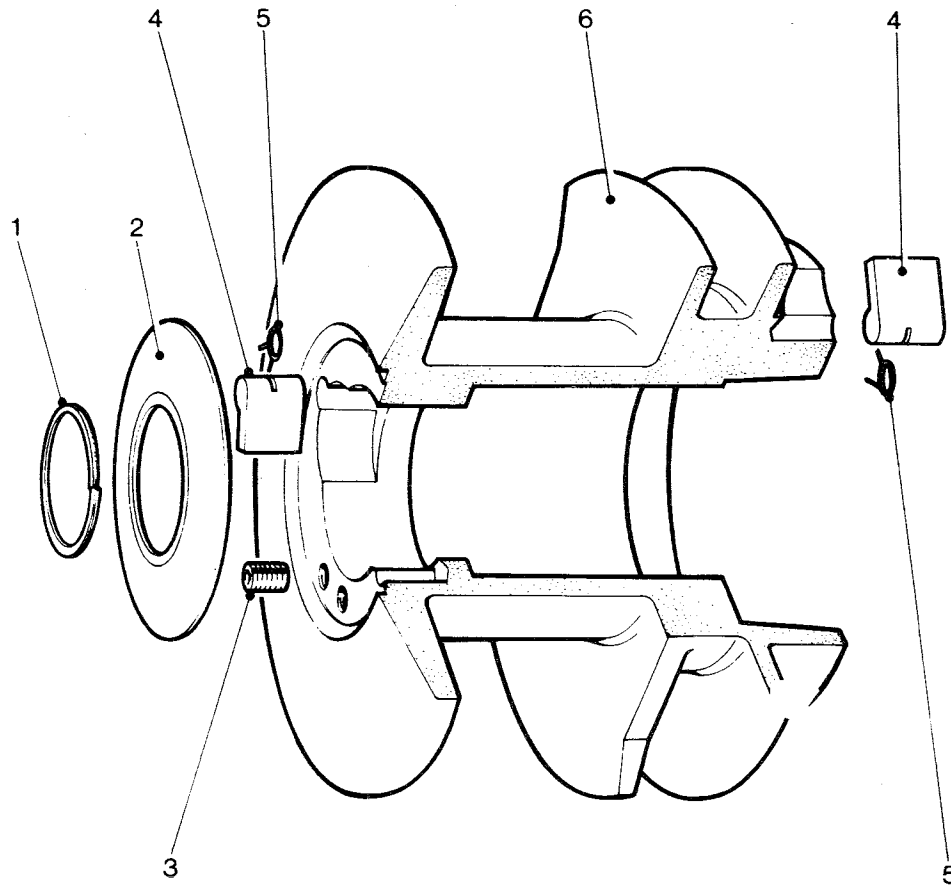

Maintenance No 1 – Mark II

- A** Remove halliard wire from drum (6) by releasing grub screws (3).
- B** Using a small screwdriver, remove circlip (1).
- C** Remove drum (6) from centre stem (11).
- D** Remove top cap (2) from drum (6).
- E** Remove bearings (8) from centre stem (11).
- F** Remove brake strap (10) and ratchet ring (9) from centre stem (11).
- G** Unscrew locking arm (14) from brake strap (10) and check thread.
- H** Clean outer surface of ratchet ring (9) with a light abrasive.
- I** Extract key (13) from centre stem (11).
- J** Remove spindle (7) from centre stem (11).
- K** Clean thoroughly all parts using kerosene (paraffin) or white spirit. Dry with a non-fluffy

cloth. Ensure that the outer surface of ratchet ring (9) and the inner surface of brake strap (10) are free from grease.

- L** Lightly grease spindle (7) and replace in centre stem (11).
- M** Insert key (13) into centre stem (11) ensuring that the key (13) is located in groove of spindle (7).
- N** Replace locking arm (14) in brake strap (10).
- O** Replace brake strap (10) on centre stem (11) ensuring that it is correctly placed on location pin (12).
- P** Check that pawls and springs (4 & 5) in top and bottom of drum (6) are free and oil lightly.
- Q** Place ratchet ring (9) on drum (6) ensuring correct location of pawls (4) in ratchet ring (9). See inset detailed drawing.
- R** Replace bearings (8) on centre stem (11) and lightly grease.
- S** Replace drum (6) and ratchet

Halliard Reel winches

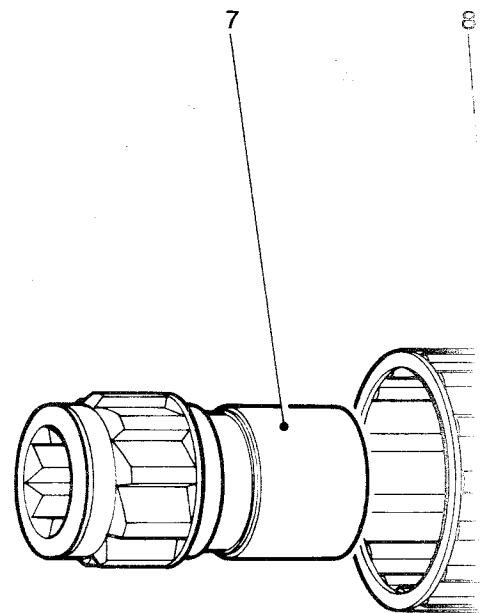

- ring (9) on centre stem (11).
- T** Replace top cap (2) and refit circlip (1) to spindle (7).

No 1 Mk. II

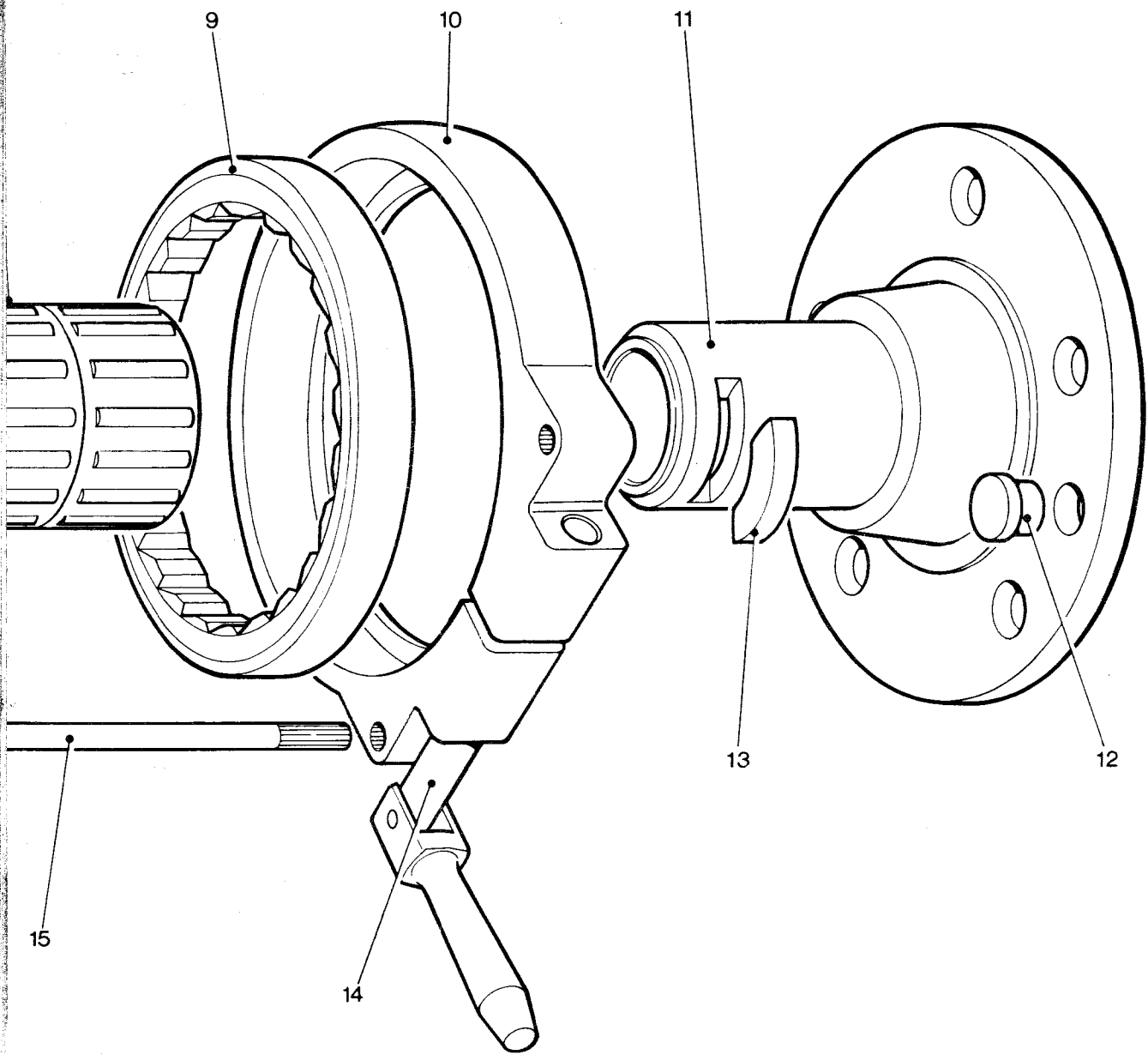

Parts list

Item Number	Part Number	Description	No. Off
1	B2075	Circlip, Spirolox	1
2	15006006	Cap	1
3	B0901	Grub Screw 1/8" UNC x 3/8" long	2
4	1260/8	Pawl	4
5	1260/7	Pawl Spring	4
6	15001022	Drum	1
7	15008003	Spindle	1
8	15008007	Cage Assembly Bearing	2
9	15001024	Ratchet Ring	1
10	15001025	Brake Strap	1
11	15001021	Centre Stem	1
12	15001008	Locating Pin	1
13	15008005	Key	1

14	15001010	Brake Lever	} * 1
	15001011	Brake Screw	
	15001009	Handle Rivet	
15	15001006	Guard Rod	2

* Fixed Assembly

Spare Parts Kit

Halliard Reel No 1—Mark II

Contents

1 x Key Pt No 15008005

4 x Spring Pt No 1260/7

4 x Pawl Pt No 1260/8

1 x Circlip Pt No B2075

2 x Grub Screw Pt No B0901

Fold out

Lewmar
Halliard Reel winches

Model 2

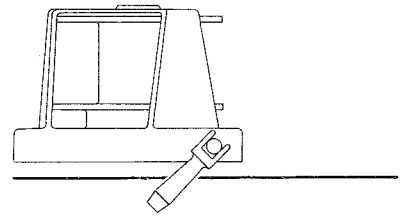

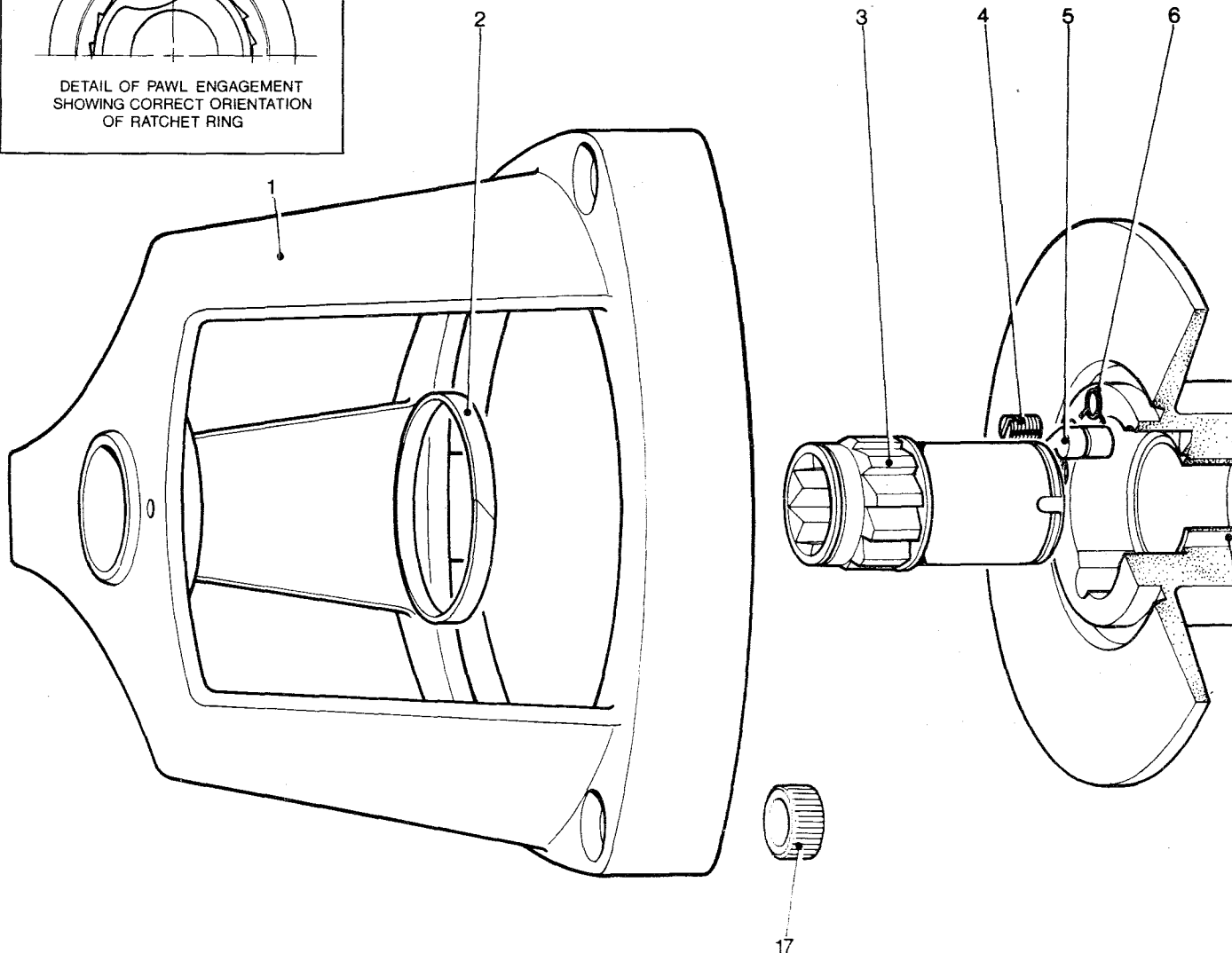
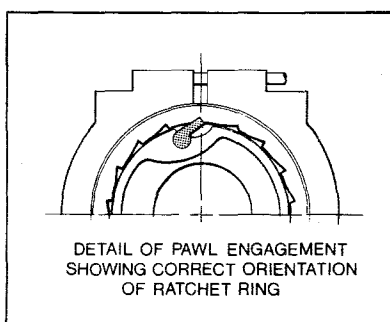

Maintenance No. 2

A Remove halliard wire from drum (8) by releasing grub screws (4) and remove winch from boat.

B Remove base plate (11) by releasing six allen screws (10).

C Remove bearing (14) from recess in drum (8).

D Unscrew locking arm (9) releasing brake strap (12).

E Lift off brake strap (12) and remove ratchet ring (13).

F Remove drum (8) from drum casing (1).

G Remove spindle (3) from drum (8) by removing circlip (15) and tab washer (7) from bottom of spindle (3).

H Clean outer surface of ratchet ring (13) with light abrasive.

I Clean thoroughly all parts using kerosene (paraffin) or white spirit. Dry with a non-fluffy cloth. Ensure that the outer surface of ratchet ring (13) and the inner surface of brake strap (12) are

free from grease.

J Check tape bearing (2) in drum casing (1).

K Check that pawls and springs (5 & 6) in top and bottom of drum (8) are free and oil lightly.

L Replace spindle (3) in drum (8) retaining it with tab washer (7) and circlip (15).

M Replace drum (8) in drum casing (1).

N Replace ratchet ring (13) on drum (8). Check that ratchet ring (13) is fitted correctly to ensure that pawls (5) are properly located in ratchet ring (13). See inset detailed drawing.

O Fit brake strap (12) over ratchet ring (13).

P Replace locking arm (9) in brake strap (12).

Q Replace bearing (14) in drum (8).

R Replace base plate (11) and fasten with six allen screws (10).

S Replace winch on boat.

No 2

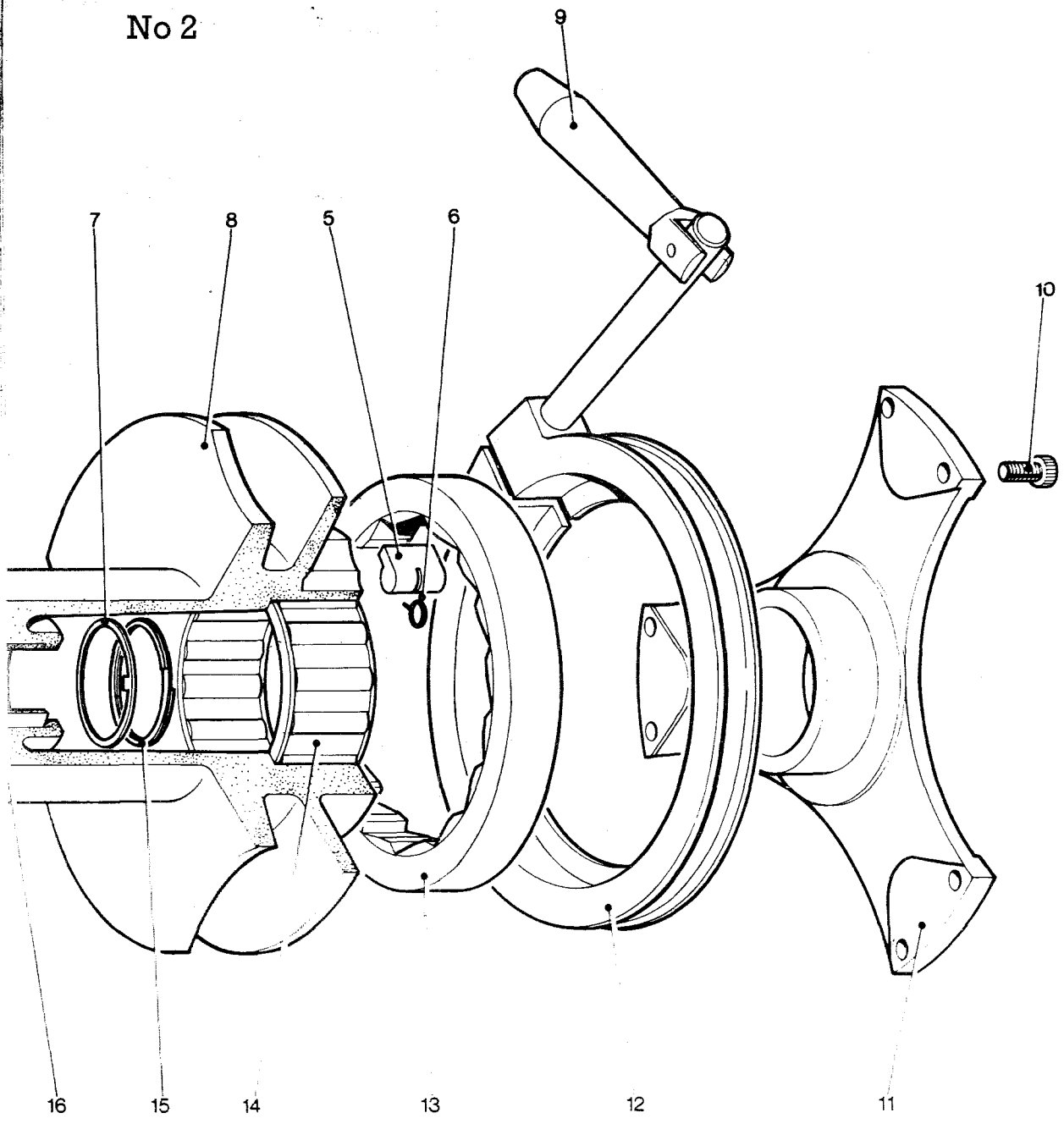

Parts list

Item Number	Part Number	Description	No. Off
1	1282/1	Drum Casing	1
2	1282/8	Bush	1
3	1266/3	Main Spindle	1
4	B0901	1/4" UNC Grub Screw x 3/8" long	2
5	1260/8	Pawl	4
6	1260/7	Pawl Spring	4
7	1266/6	Tab Washer	1
8	1282/2	Drum	1
9	15001010 15001009 1282/7	Brake Lever Handle Rivet Brake Screw	1
10	B0705	2BA Cap Screw x 1/2" long	6
11	1282/5	Base Plate	1
12	1280/4	Brake Strap	1
13	15001004	Ratchet Ring	1
14	1260/SA2	Cage Assembly Bearing	1

15	B2080	Circlip, Spirolox	1
16	1266/9	Nylon Bearing Strip	1
17	1283/13	Casing Insert	3

* Fixed Assembly

Spare Parts Kit Halliard Reel No 2 Cat No 19702400

Contents
 1 x Tab Washer Pt No 1266/6
 4 x Spring Pt No 1260/7
 4 x Pawl Pt No 1260/8
 2 x Grub Screw Pt No B0901
 1 x Circlip Pt No B2076
 1 x Circlip Pt No B2080

Lewmar
Halliard Reel winches

Model 2 x 2

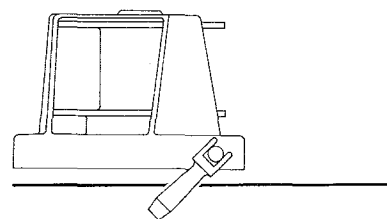

Fold out

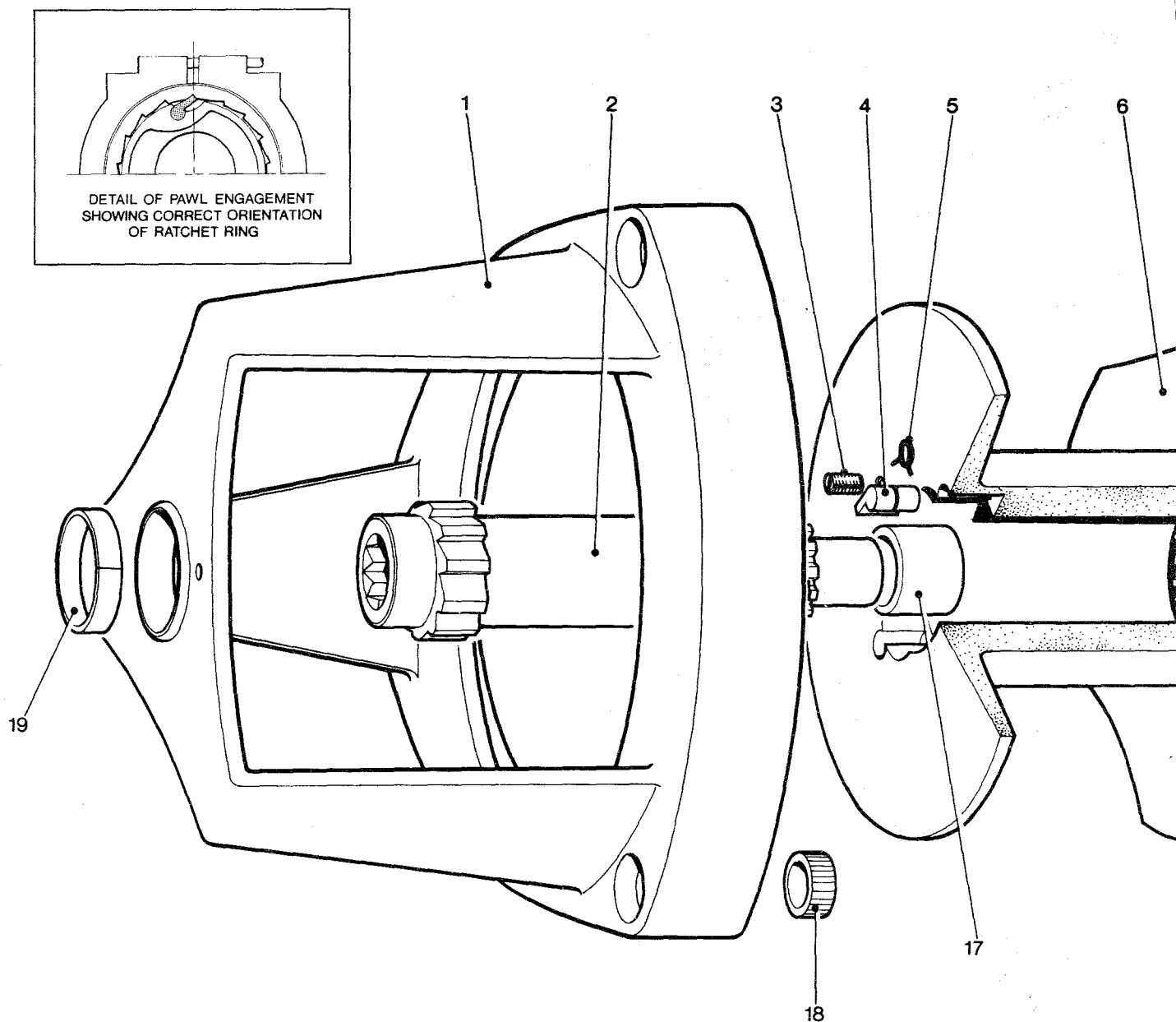
**Maintenance No. 2 x 2**

A Remove halliard wire from drum (6) by releasing grub screws (3) and remove winch from boat.

B Remove base plate (11) by releasing six allen screws (12).

C Remove locking arm (1).

D Lift off brake strap (13).

E Remove ratchet ring (14).

F Before removing planet wheel assembly (9), mark clearly each idler gear (15) and opposing gear teeth on drum (6) so that it can be reassembled in the same mesh.

G Remove planet wheel assembly (9) from spindle (2).

H Remove spindle (2), complete with bearings (7 & 8) from drum (6).

I Remove bearings (7 & 8) from spindle (2).

J Remove drum (6) from drum casing (1).

K Clean outer surface of ratchet

ring (14) with light abrasive.

L Clean thorough all parts using kerosene (paraffin) or white spirit. Dry with a non-fluffy cloth. Ensure that the outer surface of ratchet ring (14) and inner surface of brake strap (13) are free from grease.

M Check tape bearing (19) in drum casing (1).

N Check that pawls and springs (4 & 5) in drum (6) are free and oil lightly.

O Replace bearings (7 & 8) on spindle (2) and lightly grease.

P Insert spindle (2), complete with bearings (7 & 8) in drum (6).

Q Place drum (6) and spindle (2) in drum casing (1).

R Check that pawls and springs (4 & 5) on planet wheel assembly (9) are free and oil lightly.

S Lightly grease idler gears (15).

T Replace planet wheel assembly (9) on spindle (17) ensuring that gears are meshed as marked in F

above.

U Replace ratchet ring (14) on planet wheel assembly (9). Check that ratchet ring (14) is fitted correctly to ensure that pawls (4) are properly located in ratchet ring (14). See inset detailed drawing.

V Fit brake strap (13) over ratchet ring (14).

W Replace locking arm (10) in brake strap (13).

X Replace base plate (11) and fasten with six allen screws (12).

Y Replace winch on boat.

No 2 x 2

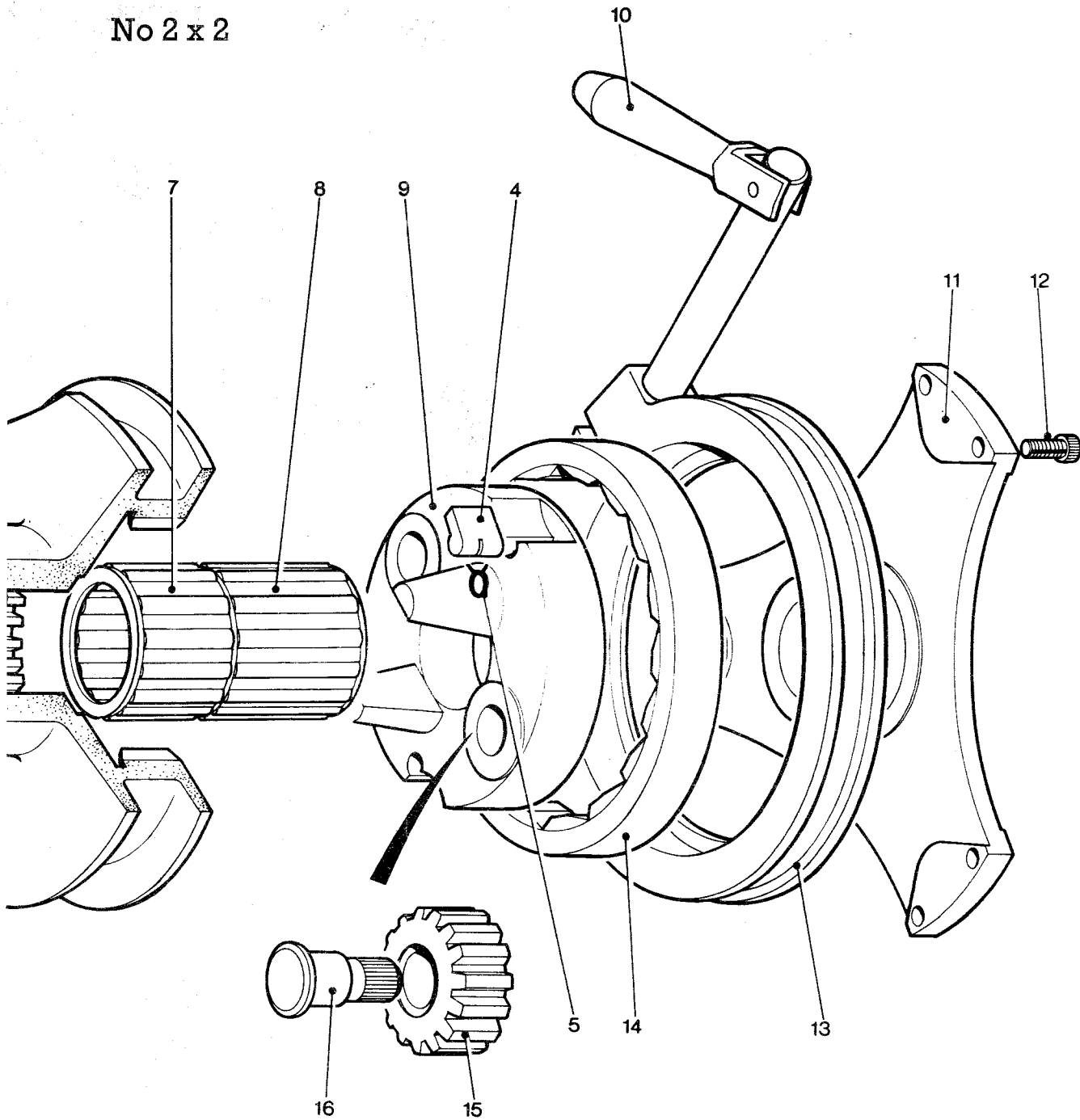

Parts list

Item Number	Part Number	Description	No. Off
1	1280/1	Drum Casing	1
2	1280/3	Spindle	1
3	B0705	1/4" UNC Socket Grub Screw x 3/8" long	2
4	1260/8	Pawl	4
5	1260/7	Pawl Spring	4
6	1280/2	Drum	1
7	1287/SA1	Cage Assembly Bearing	1
8	1264/SA2	Cage Assembly Bearing	1
9	1280/6	Planet Carriage	1
10	15001010	Brake Lever	1
	15001009	Handle Rivet	1
	1282/7	Brake Screw	1
11	1280/5	Base Plate	1

12	B0705	2BA Socket Head Cap Screw 1/2" long.	6
13	1280/4	Brake Strap	1
14	1280/7	Ratchet Ring	1
15	1280/8	Idler Gear	2
16	1280/9	Idler Spindle	2
17	B1630	Bush	1
18	1283/13	Insert	3
19	1280/10	Strip Bearing	1

* Fixed Assembly

Spare Parts Kit
Halliard Reel No 2 x 2
Cat No 19703400
Contents
4 x Spring Pt No 1260/7
4 x Pawl Pt No 1264/8
2 x Grub Screw Pt No B0904
2 x Grub Screw Pt No B0901

Fold out

Lewmar
Halliard Reel winches

Model 3

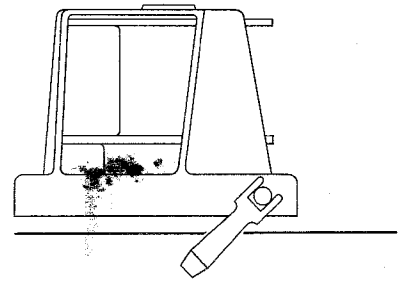

Lewmar

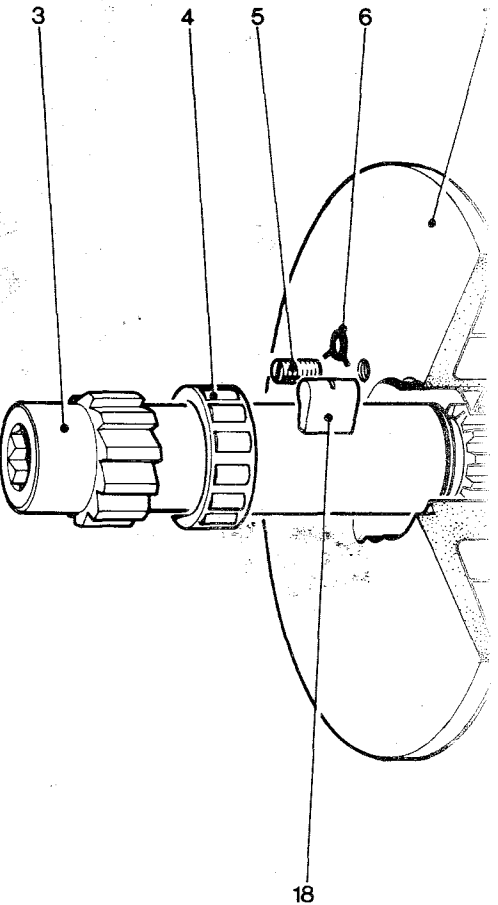
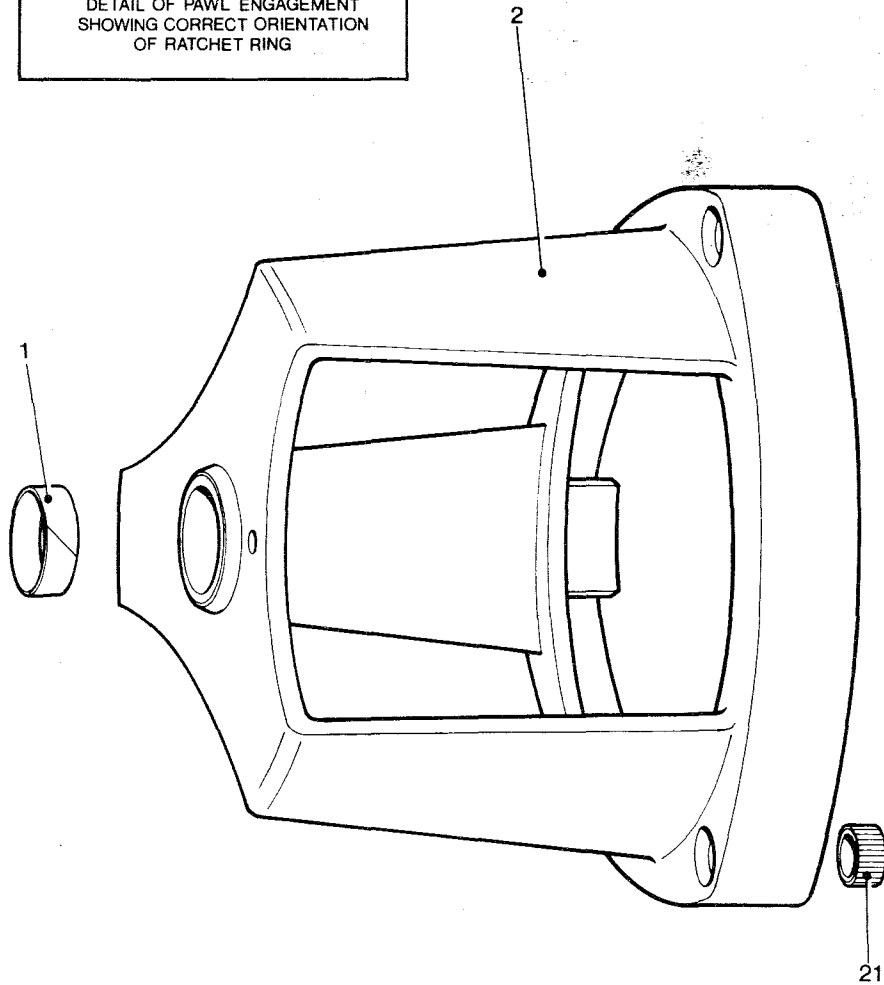
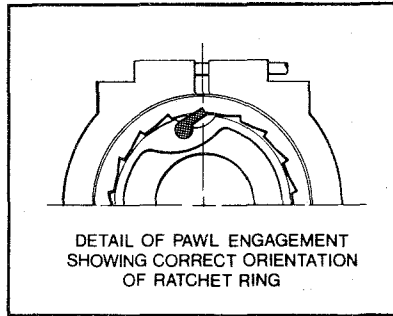

Maintenance No.3

A Remove halliard wire from drum (7) by releasing grub screws (5) and remove winch from boat.

B Remove base plate (14) by releasing six allen screws (13).

C Remove locking arm (11).

D Lift off brake strap (15).

E Remove ratchet ring (16).

F Before removing planet wheel assembly (17), mark clearly each idler gear (10) and opposing gear teeth on drum (7) so that it can be reassembled in the same mesh.

G Remove planet wheel assembly (17) from spindle (3).

H Remove spindle (3), complete with bearings (4 & 20) and spacer (8) from drum (7).

I Remove bearings (4 & 20) and spacer (8) from spindle (3) by removing circlip (19).

J Remove drum (7) from drum casing (2).

K Clean outer surface of ratchet

ring (16) with light abrasive.

L Clean thoroughly all parts using kerosene (paraffin) or white spirit. Dry with a non-fluffy cloth. Ensure that the outer surface of ratchet ring (16) and inner surface of brake strap (15) are free from grease.

M Check tape bearing (1) in drum casing (2).

N Check that pawls and springs (18 & 6) in drum (7) are free and oil lightly.

O Replace bearings (4 & 20) and spacer (8) on spindle (3) retaining them with circlip (19) and lightly grease.

P Insert spindle assembly (3) in drum (7).

Q Place drum (7) and spindle (3) in drum casing (2).

R Check that pawls and springs (18 & 6) on planet wheel assembly (17) are free and oil lightly.

S Lightly grease idler gears (10).

T Replace planet wheel assembly (17) on spindle (3) ensuring that

Halliard Reel winches

gears are meshed as marked in F above.

U Replace ratchet ring (16) on planet wheel assembly (17). Check that ratchet ring (16) is fitted correctly to ensure that pawls (18) are properly located in ratchet ring (16). See inset detailed drawing.

V Fit brake strap (15) over ratchet ring (16).

W Replace locking arm (11) in brake strap (15).

X Replace base plate (14) and fasten with six allen screws (13).

Y Replace winch on boat.

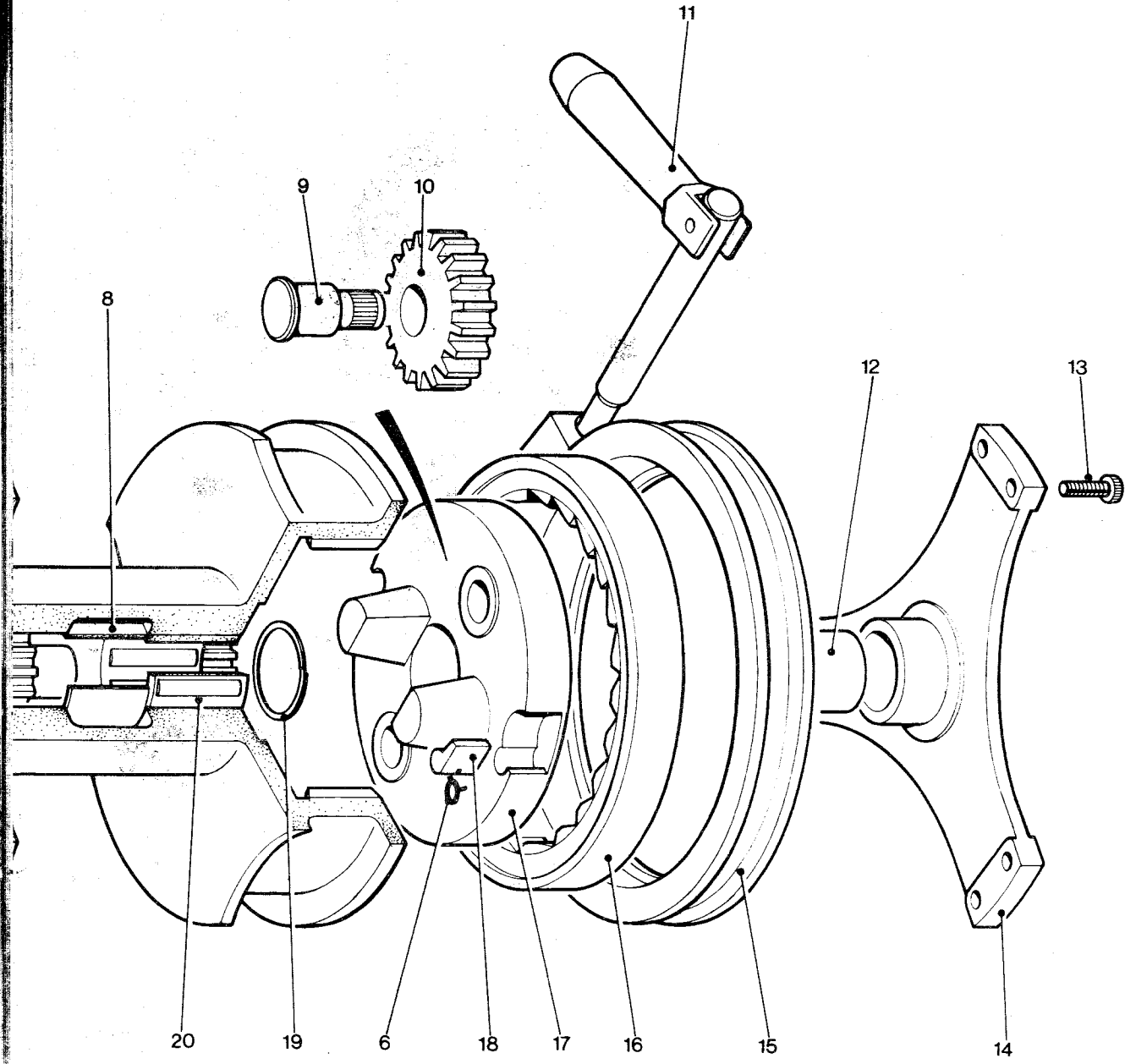

Parts list

Item Number	Part Number	Description	No. Off
1	1283/12	Tape Bearing	1
2	1283/1	Drum Casing	1
3	1283/7	Main Spindle	1
4	1287/SA1	Cage Assembly Bearing	1
5	B0901	1/4" x 20 UNC Grub Screw x 3/8" long	2
6	1260/7	Pawl Spring	4
7	1283/2	Drum	1
8	1283/15	Tube Spacer	1
9	1283/9	Idler Gear Spindle	2
10	1283/8	Idler Gear	2
11	15001009	Handle Rivet	* 1
	1283/20	End Piece	
	1283/19	Brake Lever	
	1283/10	Brake Screw	
12	B1630	Bush	1

13	B0705	2BA Cap Hd Socket Screw 1/2" long	6
14	1283/5	Base Plate	1
15	1283/4	Brake Strap	1
16	1283/3	Ratchet Ring	1
17	1283/6	Planet Carriage	1
18	1264/8	Pawl	4
19	B2075	Spirolox Circlip	1
20	1264/SA2	Cage Assembly Bearing	1
21	1283/13	Casing Insert	3

* Fixed Assembly

Spare Parts Kit
Halliard Reel No 3
Cat No 19703400

Contents
4 x Spring Pt No 1260/7
4 x Pawl Pt No 1264/8
2 x Grub Screw Pt No B0904
2 x Grub Screw Pt No B0901